



**ORDINARY MEETING OF COUNCIL
TO BE HELD ON TUESDAY, 3 AUGUST 2004 AT 7.00PM
LEVEL 3, COUNCIL CHAMBERS**

A G E N D A

**** ** * ** * ** ***

NOTE: For full details, see Council's website –
www.kmc.nsw.gov.au under the link to Business Papers

APOLOGIES

DECLARATION OF PECUNIARY INTEREST

CONFIRMATION OF REPORTS TO BE CONSIDERED IN CLOSED MEETING

ADDRESS THE COUNCIL

NOTE: Persons who address the Council should be aware that their address will be tape recorded.

DOCUMENTS CIRCULATED TO COUNCILLORS

CONFIRMATION OF MINUTES

Minutes of Ordinary Meeting of Council

File: S02131

Meeting held 20 July 2004

Confirmation of Minute No 328 – General Matter – Federal Office of Road Safety National Black Spot Program - Memorandum from Senior Governance Officer dated 28 July 2004.

Confirmation of Minute No 344 –Inappropriateness of Site Cover – Discussion with Minister – Memorandum from Senior Governance Officer dated 28 July 2004.

Minutes of Ordinary Meeting of Council

File: S02131

Meeting held 27 July 2004

Minutes numbered 349 to 361

MINUTES FROM THE MAYOR

PETITIONS

REPORTS FROM COMMITTEES

Minutes of Ku-ring-gai Traffic Committee

File: S02110

Meeting held 22 July 2004

Minutes numbered KTC18 to KTC21

GENERAL BUSINESS

- i. *The Mayor to invite Councillors to nominate any item(s) on the Agenda that they wish to have a site inspection.*
- ii. *The Mayor to invite Councillors to nominate any item(s) on the Agenda that they wish to adopt in accordance with the officer's recommendation and without debate.*

GB.1 Strategies to Manage and Protect Unmade Roads - Summary of Surveyed Roads 1

File: S03498

To report to Council on strategies to manage and protect unmade roads.

Recommendation:

That the unmade roads located within bushland be managed by Open Space and closure be considered on a priority basis following a detailed site review.

GB.2 Deputy Mayoral Term - 2004/2005 19

File: S02356

To give consideration to setting the date for the election of the Deputy Mayor or an extension of the Term of Office until September 2005.

Recommendation:

That the 2004/2005 election of the Deputy Mayor be held at the Ordinary Meeting of Council on Tuesday, 7 September 2004.

GB.3 National General Assembly of Local Government 2004 22

File: S02133

For Council to determine its elected delegates to the 2004 National General Assembly of Local Government.

Recommendation:

That Council determines if it wishes to send delegates or submit motions for debate at the 2004 National General Assembly of Local Government.

GB.4 1234 - 1274 Pacific Highway and 1 Beechworth Road, Pymble - Proposed Rezoning - Additional Information Received 37

File: S02036

To provide Council with additional information on the sites 1234-1274 Pacific Highway and 1 Beechworth Road, Pymble, that have previously been considered for rezoning.

Recommendation:

That Council receive and note the information. That Council advise the property owners 1234-1274 Pacific Highway and 1 Beechworth Road, Pymble that any future consideration of these sites for rezoning will only be through the lodgement of a formal rezoning application.

EXTRA REPORTS CIRCULATED AT MEETING

MOTIONS OF WHICH DUE NOTICE HAS BEEN GIVEN

NM.1 Retail Centres 48

File: S02921

Notice of Motion from Councillor L Bennett dated 19 July 2004.

I move:

That a site inspection of Retail Centres be arranged.

NM.2 Clause 251(6) of LEP 194 49

File: S02036

Notice of Motion from Councillor L Bennett dated 20 July 2004.

I move:

- A. That a Report be brought to council to consider amending Clause 25I(6) of LEP 194 to allow land adjoining that for medium density to be counted as part of the site (with no change to its zoning status).
- B. That the Report address the following issues:
 - 1. the ability of such a change to minimise the impact of 5 story development on adjoining dwellings in single residential zones.
 - 2. whether the controls in LEP 194 and DCP 55 (including draft controls) would be achievable given an amendment to Clause 25I(6)
 - 3. what negative impacts might result from an amendment to clause 25I(6) including any changes to bulk and scale
 - 4. what the scope of any amendment could be including whether it could be restricted to land zoned for single residential dwellings with street frontage or up to a maximum size
- C. That a map of interface sites that would be affected be prepared.
- D. That funding for implementation be sourced in the first instance from any budgetary surplus in the current financial year to a maximum of \$20,000 and that the Report come to Council no later than September 2004.

**BUSINESS WITHOUT NOTICE - SUBJECT TO CLAUSE 14 OF MEETING
REGULATION**

QUESTIONS WITHOUT NOTICE

INSPECTIONS COMMITTEE - SETTING OF TIME, DATE AND RENDEZVOUS

**CONFIDENTIAL BUSINESS TO BE DEALT WITH IN CLOSED MEETING - PRESS &
PUBLIC EXCLUDED**

**** ** ***

STRATEGIES TO MANAGE AND PROTECT UNMADE ROADS - SUMMARY OF SURVEYED ROADS

EXECUTIVE SUMMARY

PURPOSE OF REPORT:	To report to Council on strategies to manage and protect unmade roads.
BACKGROUND:	Council has 99 unmade roads of which 52 occur in bushland.
COMMENTS:	Management of unmade roads rests with Open Space and Technical Services. As part of a longer term strategy to secure the future of the unmade roads as bushland, it may be necessary to either close the roads and/or reallocate responsibility to Open Space where the value of the bushland is high.
RECOMMENDATION:	That the unmade roads located within bushland be managed by Open Space and closure be considered on a priority basis following a detailed site review.

PURPOSE OF REPORT

To report to Council on strategies to manage and protect unmade roads.

BACKGROUND

The 2003/04 Management Plan required a report be prepared for the consideration of Council on strategies to manage and protect unused roads. This report seeks to address this task by identifying unmade roads, taking into account their future needs and existing zoning. Particular focus has been given to those unmade roads in bushland. This reflects the objective behind the task to “retain and restore the quality and connectivity of terrestrial and aquatic habitats”.

An unmade road is a road that is unformed. This means that it has no kerb or gutter or formed surface. It is quite possible that cars might still be able to use it, although in most cases unmade roads still contain uncleared natural vegetation and are therefore unusable for traffic particularly those within bushland.

Unmade roads occur for a variety of reasons. Often it is because a residential development was planned but not constructed, or the development was only partly completed. Sometimes unmade roads are a result of superior alternative routes being developed. They can also occur because of budget restraints not permitting their immediate construction.

There are a number of mechanisms to deal with unmade roads that depend on the status of the unmade road. Where an unmade road is classified as a public road under the *NSW Roads Act 1993*, Council must make an application to the Minister for Roads under Section 34 of the *Roads Act* to remove the said road. If the application is successful the Minister “may by notice, published in the Gazette, close the public road concerned”. The effect of this decision is to allow the existing uses permitted under the zoning to occur without consequence of the impacts of a future road and associated infrastructure.

An unmade road can also be considered as a “paper road”, being recognised as a potential road during the development of a subdivision plan, though never recognised as a public road under the *Roads Act*. In this situation the unmade road is likely to have its own lot and deposit plan number, and be identified on Council’s planning map. The ownership of these unmade roads may rest with Council or the State (Crown), depending on the status of the land ownership at the time of the subdivision plan. To remove these unmade roads would require a similar approach to that of public roads, although the final decision rests with Council, not the Minister of Roads.

As part of the review, 99 unmade roads have been identified. These have been divided into three groups: Group 1 containing those unmade roads that were entirely located within Council managed Open Space areas and consequently zoned as Open Space (6A); Group 2 are unmade roads zoned as roads under Council’s Planning Scheme Ordinance; and Group 3 are unmade roads located within and zoned as Residential 2 (C). The table below summaries the numbers and existing land use management affecting the unmade roads. It should be noted that roads are permitted in all zones.

Item 1

S03498
14 July 2004

Group	Zoning	Classification	Number
1	Open Space (6A)	Natural Areas	45
		Urban Parks	2
		Sports Reserve	5
2	Roads	Proposed County Roads - adjoining/surrounding land <ul style="list-style-type: none"> • Bushland 2 • Urban Park 1 • Private Property 2 	5
		Other Roads Adjoining/surrounding land <ul style="list-style-type: none"> • Bushland 20 • Urban Park 1 • Sports Reserve 2 • Private Property 18 	41
3	Residential	Residential	1

Management of unmade roads rests with either Technical Services or Open Space. Where the unmade roads are located in bushland, it is usually managed by Council's bushland section. Exceptions exist where an unmade road portion is zoned as a road and occurs outside a continuous stretch of bushland.

COMMENTS

The intention of this report is to prepare and implement effective programs and strategies to minimise the impacts of activities that damage habitats and assist in the protection of threatened species. This reflects concern that some unmade roads may promote inappropriate development that would otherwise present a risk to the long term management of bushland and associated habitats.

A preliminary review of all the unmade roads was undertaken in terms of their bushland value (Attachment 1). This review considered the current zoning; the vegetation associations; whether endangered flora or fauna was present or formed part of an endangered vegetation community; if it had potential as a bushland corridor; its significance for asset protection relating to bushfire hazard; and whether it was within a bushcare site.

An extension to this assessment sought to prioritise the unmade roads on the basis of their environmental and social significance. Attachment 2 provides the results of this prioritisation. Scores were given to each site according to:

1. whether they occur in a natural area, park, sportsground or golfcourse (Max 20)
2. if endangered flora and fauna has been recorded (20)
3. whether the site forms part of a potential bushland corridor (10)

Item 1

S03498
14 July 2004

4. if it can be utilised as a strategic site for asset protection (10)
5. if a bush care site is present (15)

In determining the most appropriate form of long term management, consideration was initially given to those unmade roads managed by Open Space. In most situations the current management, be it through noxious weed control, fire management, regeneration or bushcare is sufficient to ensure vegetation and habitats sustain into the future. Notwithstanding this response, there are some sites where reclassifying or renaming the unmade road to bushland may prove beneficial. This can be investigated on a priority basis as identified in Attachment 2.

Where an unmade road occurs in bushland and is zoned as Road, consideration is given to its day to day management and the expertise in the organisation to manage these parcels. In all situations the medium term option is to transfer the maintenance to Open Space.

Closing the road or removal of it from the Planning Scheme Ordinance should be a long term strategy for only those roads under particular threat. Presently it is not considered that this option be taken across all sites, given the resources and time involved unless on a site by site basis. Rather it is recommended that 4 sites per year be reviewed, reflecting the priority given in Attachment 2, till such time as the long term future can be satisfied.

CONSULTATION

As part of the review and identification of unmade roads in bushland, the Ku-ring-gai Natural Areas Advisory Committee was consulted and briefed on the development of this report. It would also be expected that if Council supports to seek “closure” of any roads following a review that such deliberations be referred to the new Bushland, Catchments and Natural Areas Reference Group. Other consultation with the public would also occur through Council’s website, with the Ku-ring-gai Bushcare Association and other local environment groups. Formal notification processes would be required to residents living and managing properties immediately adjoining an unmade road if formal closure was sought.

FINANCIAL CONSIDERATIONS

The rezoning of unmade roads is likely to impact on three departments of Council, Open Space, Technical Services and Planning and Environment. In this respect and given existing priorities, up to four unmade roads can be reviewed each year. Changes in day to day management of sites in bushland to Open Space are unlikely to have significant impact.

CONSULTATION WITH OTHER COUNCIL DEPARTMENTS

Technical Services and Planning and Environment Departments have been consulted in the preparation of this report.

SUMMARY

There are 99 unmade roads across the Ku-ring-gai local government area. Fifty two of these are located within bushland and managed by Open Space. Forty seven of these are also located mostly within bushland and managed by Technical Services. Given the resources to either close or remove from the Planning Scheme Ordinance an unmade road, it is recommended in the first instance that Open Space assume day to day management responsibility for all unmade roads in bushland and then up to four sites be investigated each year as to their potential and value for reclassifying.

RECOMMENDATION

- A. That Council receive and note the report.
- B. That unmade roads occurring in Bushland be managed by Open Space.
- C. That the four highest priority unmade roads be reviewed each year for reclassification.

Steven Head
Director Open Space

Peter Davies
Manager Sustainability & Catchment
Management

Attachments:

- 1. List and Analysis of unmade roads within the Ku-ring-gai local government area.**
- 2. Priority List of unmade roads within the Ku-ring-gai local government area.**

Attachment 1.
Unmade Roads across the Ku-ring-gai Local Government Area. Review June 2004

KMAP Ref.	Road Name or Ref.	Suburb	Current Land Use Type & or Manager	Adjoining Land Manager	Current Zoning	Recommended Zoning	Recommended Future Land Use Type & or Manager	Is it an Informal Road or other Structure	Vegetation Association	Endang'd Flora	Endang'd Fauna	Bushland Corridor Potential	Asset Protection Significance	Bushcare Site
34b	Aleta Close	Wahroonga	Natural Area	Natural Area & Nat. Park	Open Space 6a	Open Space - 6a	Natural Area	Fire Trail	Not checked	Yes - Db	No	No	Yes	No
18c	Alice St.	Turramurra	Technical Services	Residential	Road	Road	Technical Services	No	Not Currently Mapped - Originally STIF T3d	No	No	Yes	No	No
47c	Aline St.	Killara	Natural Area	Natural Area	Open Space 6a	Open Space - 6a	Natural Area	No site visit	Not checked	Yes - Ec	Yes - Pp & Pa	Yes	No	No
18b	Allara Ave	North Turramurra	Natural Area	Natural Area	Open Space 6a	Open Space - 6a	Natural Area	No site visit	Not checked	No	No	No	Yes	No
58b	Attunga Rd.	Roseville Chase	Technical Services	Private O/S, Golf Course	Road	Road	Technical Services	Golf Course	Not Currently Mapped - Originally Sydney Sandstone Ridgetop L2b	No	No	Yes	No	No
19b	Ayres Rd 1.	St. Ives	Technical Services	Residential	Road	Open Space - 6a	Natural Area	No	Sydney Sandstone Ridgetop L3c	No	No	Yes	Yes	No
20b	Ayres Rd 2.	St. Ives	Technical Services	Residential	Road	Open Space - 6a	Natural Area	Concrete Steps	Sydney Sandstone Ridgetop L3c	No	No	Yes	Yes	No
55a	Beaumont Rd.	Killara	Natural Area	Natural Area	Road	Open Space - 6a	Natural Area	No site visit	Not checked	No	No	Yes	Yes	Yes
28d	Beltana Place	Wahroonga	Natural Area	Natural Area & National Park	Open Space 6a	Open Space - 6a	Natural Area	No	Not checked	No	No	Yes	Yes	No
6d & 12b	Bertrand Rd	North Turramurra	Golf Course	Golf Course, Natural Area, SAOS	Open Space 6a	Open Space - 6a	Sportsground	No	Not checked	No	No	No	No	No
34b	Between Leuna Ave & Yanilla Ave.	Wahroonga	Natural Area	Natural Area	Open Space 6a	Open Space - 6a	Natural Area	No	Not checked	No	No	Yes	No	No

Attachment 1.
Unmade Roads across the Ku-ring-gai Local Government Area. Review June 2004

KMAP Ref.	Road Name or Ref.	Suburb	Current Land Use Type & or Manager	Adjoining Land Manager	Current Zoning	Recommended Zoning	Recommended Future Land Use Type & or Manager	Is it an Informal Road or other Structure	Vegetation Association	Endang'd Flora	Endang'd Fauna	Bushland Corridor Potential	Asset Protection Significance	Bushcare Site
43a	Between Ravenhill Rd & Comenara Parkway	Turrumurra	Natural Area	Private Open Space, Urban Park, Bushcare site	Road	Open Space - 6a	Natural Area	No site visit	Not checked	No	Yes - Cf	Yes	Yes	Yes
23a	Borambil St.	Warrawee	Technical Services	Urban Park	Road	Open Space - 6a	Natural Area	No	Not Currently Mapped - Originally Blue Gum High Forest T3a	No	No	Yes	Yes	No
11a	Boundary Rd 1.	North Wahroonga	Technical Services	Residential	Road	Open Space - 6a	Natural Area	No	Not Currently Mapped - Originally STIF T3d	No	No	No	Yes	No
11a	Boundary Rd. 2.	North Wahroonga	Sportsground	Sportsground	Road	Open Space - 6a	Sportsground	No	Not Currently Mapped - Originally STIF T3d	No	No	Yes	No	No
11b	Boundary Rd 3.	North Wahroonga	Technical Services	Natural Area	Road	Open Space - 6a	Natural Area	No	Not Currently Mapped - Originally Sydney Sandstone Ridgetop L2b	No	No	No	Yes	No
59c	Boundary St. 1.	Roseville	Technical Services	Residential	Road	Open Space - 6a	Natural Area	Concrete Steps	Not Currently Mapped - Originally Sydney Sandstone Ridgetop L3c	No	No	Yes	Yes	No

Attachment 1.
Unmade Roads across the Ku-ring-gai Local Government Area, Review June 2004

KMAP Ref.	Road Name or Ref.	Suburb	Current Land Use Type & or Manager	Adjoining Land Manager	Current Zoning	Recommended Zoning	Recommended Future Land Use Type & or Manager	Is it an Informal Road or other Structure	Vegetation Association	Endang'd Flora	Endang'd Fauna	Bushland Corridor Potential	Asset Protection Significance	Bushcare Site
59c	Boundary St. 2.	Roseville	Technical Services	Residential	Road	Open Space - 6a	Natural Area	No	Not Currently Mapped - Originally Sydney Sandstone Gully M3e	No	No	Yes	Yes	No
59c	Boundary St. 3.	Roseville	Technical Services	Natural Area	Road	Open Space - 6a	Natural Area	No	Not Currently Mapped - Originally Sydney Sandstone Gully M3e	No	No	Yes	Yes	No
63b	Boundary St. 4.	Roseville	Technical Services	Residential	Road	Road	Technical Services	Yes	Not Currently Mapped - Originally Sydney Sandstone Ridgetop L3c	No	No	Yes	Yes	No
28a	Browns Rd	Wahroonga	Natural Area	Natural Area	Open Space 6a	Open Space - 6a	Natural Area	No	Not checked	No	No	Yes	Yes	No
38b	Burraneer Ave.	St Ives	Technical Services	Bushcare site	Road	Open Space - 6a	Natural Area	No	Sydney Sandstone Ridgetop L3c	No	No	Yes	Yes	No
50c	Bushlands Ave.	Killara	Natural Area	Natural Area	Road	Open Space - 6a	Natural Area	No site visit	Not checked	No	No	Yes	Yes	No
63b	Calga St.	Roseville	Technical Services	Residential	Road	Open Space - 6a	Natural Area	No	Not Currently Mapped - Originally Sydney Sandstone Ridgetop L3c	No	No	No	No	No

Attachment 1.
Unmade Roads across the Ku-ring-gai Local Government Area. Review June 2004

KMAP Ref.	Road Name or Ref.	Suburb	Current Land Use Type & or Manager	Adjoining Land Manager	Current Zoning	Recommended Zoning	Recommended Future Land Use Type & or Manager	Is it an Informal Road or other Structure	Vegetation Association	Endang'd Flora	Endang'd Fauna	Bushland Corridor Potential	Asset Protection Significance	Bushcare Site
35c	Canoon Rd.	Turramurra	Natural Area & Sports Reserve	Natural Area & Sports Reserve	Open Space 6a	Open Space - 6a	Natural Area & Sportsground	Yes	Not checked	Yes - Db	No	Yes	Yes	No
10b	Carrington Rd	North Wahroonga	Technical Services	Sports Reserve	Road	Open Space - 6a	Natural Area	Yes	Not Currently Mapped - Originally STIF T3d	No	No	No	Yes	No
58b	Chase Ave.	Roseville Chase	Technical Services	Natural Area	Road	Road	Technical Services	Yes	Sydney Sandstone Ridgetop M2a	No	Yes - MSh & NSt	No	No	No
5d	Cliff Ave	North Wahroonga	Sports Reserve	Natural Area	Open Space 6a	Open Space - 6a	Sportsground	No	Not checked	No	No	No	No	No
5c	Coonanbarra Rd	North Wahroonga	Technical Services & SAOS	SAOS	Road - Open Space - 6a	Road	Technical Services	Yes	Not Currently Mapped - Originally Sydney Sandstone Gully M3e & STIF T3b	No	No	Yes	Yes	No
29b	Cooper Cres.	Wahroonga	Natural Area	Residential	Road	Open Space - 6a	Natural Area	Yes	Not Currently Mapped - Originally STIF T3b	No	No	Yes	Yes	Yes
35a	Crown Ave.	Turramurra	Natural Area	Natural Area & SAOS	Open Space 6a & Road - County Proposed	Open Space - 6a	Natural Area	No site visit	Not checked	No	No	Yes	No	No

Attachment 1.
Unmade Roads across the Ku-ring-gai Local Government Area. Review June 2004

KMAP Ref.	Road Name or Ref.	Suburb	Current Land Use Type & or Manager	Adjoining Land Manager	Current Zoning	Recommended Zoning	Recommended Future Land Use Type & or Manager	Is it an Informal Road or other Structure	Vegetation Association	Endang'd Flora	Endang'd Fauna	Bushland Corridor Potential	Asset Protection Significance	Bushcare Site
46c	Cunliffe Rd.	Killara	Technical Services	Residential	Road	Open Space - 6a	Natural Area	Concrete Pathway	Not Currently Mapped - Originally Sydney Sandstone Ridgetop L3c	No	No	Yes	No	No
6d & 12b	Curagul Rd	North Turramurra	Golf Course	Golf Course, Sports Reserve, Natural Area, SAOS	Open Space 6a	Open Space - 6a	Sportsground	Yes	Not checked	No	No	No	No	No
13c	Dalton Rd 1.	St Ives	Technical Services	Natural Area & SAOS	Road	Road	Technical Services	Yes	Sydney Sandstone Ridgetop L3c	Yes - HI	No	No	No	No
13d	Dalton Rd 3.	St Ives	Natural Area	Natural Area	Open Space 6a	Open Space - 6a	Natural Area	No site visit	Not checked	No	No	Yes	Yes	No
58b	Davidson Pde.	Roseville Chase	Natural Area	Natural Area	Open Space 6a	Open Space - 6a	Natural Area	No site visit	Not checked	No	No	Yes	Yes	No
12c	Endeavour St.	North Wahroonga	Technical Services	Residential	Road - County Proposed	Open Space - 6a	Natural Area	No	Not Currently Mapped - Originally Blue Gum High Forest T3a	No	No	Yes	No	No
32c	Eucalyptus Close	Pymble	Technical Services	Natural Area	Road	Open Space - 6a	Natural Area	No	Blue Gum High Forest T3a & STIF T3d	No	No	Yes	Yes	No
52a	Fairlight Ave.	East Killara	Technical Services	Natural Area	Road	Open Space - 6a	Natural Area	No	Sydney Sandstone Ridgetop L3c	No	No	No	No	Yes

Attachment 1.
Unmade Roads across the Ku-ring-gai Local Government Area. Review June 2004

KMAP Ref.	Road Name or Ref.	Suburb	Current Land Use Type & or Manager	Adjoining Land Manager	Current Zoning	Recommended Zoning	Recommended Future Land Use Type & or Manager	Is it an Informal Road or other Structure	Vegetation Association	Endang'd Flora	Endang'd Fauna	Bushland Corridor Potential	Asset Protection Significance	Bushcare Site
35a	Field of Mars Ave.	Wahroonga	Natural Area	Natural Area & SAOS	Open Space 6a & Road - County Proposed	Open Space - 6a	Natural Area	No site visit	Not checked	No	No	Yes	No	No
26a	Flinders Ave.	St Ives	Technical Services	Residential	Road	Open Space - 6a	Natural Area	Yes	Originally Duffys Forest M3b	No	No	Yes	No	No
42a	Hall St.	Turramurra	Technical Services	Natural Area	Road - County Proposed	Road	Technical Services	Yes	Sydney Sandstone Ridgetop L3c	No	Yes - Nst	Yes	No	No
44a	Holford Cres. 1.	Gordon	Residential 2c	Residential	Residential 2c with Local Road Proposed	Residential 2c with Local Road Proposed	Residential 2c	No	Not Currently Mapped - Originally STIF T3b	No	No	Yes	No	No
29c	Kalang Pde.	Wahroonga	Technical Services	Residential	Road	Open Space - 6a	Natural Area	No	Not Currently Mapped - Originally STIF T3d	No	No	Yes	No	Yes
65b	Kimo St.	Roseville	Technical Services	Natural Area	Road	Open Space - 6a	Natural Area	No	Sydney Sandstone Gully M3e	No	Yes - Pp	Yes	Yes	Yes
42c & 48a	Kissing Point Rd.	Turramurra	Technical Services	Urban Park, Natural Area, Power Line Easement	Road - County Proposed	Open Space - 6a	Natural Area	Yes	Sydney Sandstone Gully M3e	Yes - Db	Yes - Cf	Yes	Yes	Yes
13d	Kitchener St.	St Ives	Natural Area	Natural Area	Open Space 6a	Open Space - 6a	Natural Area	No site visit	Not checked	No	No	Yes	No	No
23b	Laurence Ave.	Turramurra	Technical Services	Natural Area & Sports Reserve	Road	Open Space - 6a	Natural Area	No	Blue Gum High Forest T3a	No	No	No	No	No
34b	Leuna Ave.	Wahroonga	Natural Area	Natural Area	Open Space 6a	Open Space - 6a	Natural Area	No	Not checked	Yes - Db	Yes - Cf	Yes	Yes	No

Attachment 1.

Warragundi Road across the Warringal and Local Government Area. Review June 2001

WMAF Ref.	Road Name or Ref.	Suburb	Current Land Use Type & or Manager	Adjoining Land Manager	Current Zoning	Recommended Zoning	Recommended Future Land Use Type & or Manager	Is it an Informal Road or other Structure	Vegetation Association	Endang'd Flora	Endang'd Fauna	Bushland Corridor Potential	Asset Protection Significance	Bushcare Site
45a	Melkin End	Gordon	Technical Services	Residential	Road	Open Space - 6a	Natural Area	No	Not Currently Mapped - Originally STIF T3b	No	No	Yes	Yes	No
45a	Minns Rd.	Gordon	Technical Services	Residential	Road	Open Space - 6a	Natural Area	No	Not Currently Mapped - Originally STIF T3d	No	Yes - NSt & Pp	Yes	No	No
45d	Montah Ave	Killara	Technical Services	Natural Area	Road	Open Space - 6a	Natural Area	No	STIF T3d	No	No	No	Yes	No
29c	Moona Pde.	Wahroonga	Technical Services	Natural Area	Road	Open Space - 6a	Natural Area	No	Not Currently Mapped - Originally STIF T3d	No	No	Yes	No	No
11d	Morris Ave	North Wahroonga	Technical Services	Residential	Local Roads Widening	Road	Technical Services	Yes	Not Currently Mapped - Originally STIF T3b	No	No	Yes	No	No
34b	Mutama St.	Wahroonga	Technical Services	Natural Area	Road - County Proposed	Open Space - 6a	Technical Services Road	No	STIF T3b & Sydney Sandstone Ridgetop L3c	No	No	Yes	Yes	Yes
30b	Near Eastern end of Warragal Rd. 1.	Turrumurra	Technical Services	Railways	Road	Road	Technical Services	Yes	Blue Gum High Forest T3a	No	No	Yes	No	No
30b	Near Eastern end of Wambool Rd. 2.	Turrumurra	Technical Services	Railways	Road	Open Space - 6a	Natural Area	No	Blue Gum High Forest T3a	No	No	Yes	No	No

Attachment 1.
Unmade Roads across the Ku-ring-gai Local Government Area. Review June 2004

KMAP Ref.	Road Name or Ref.	Suburb	Current Land Use Type & or Manager	Adjoining Land Manager	Current Zoning	Recommended Zoning	Recommended Future Land Use Type & or Manager	Is it an Informal Road or other Structure	Vegetation Association	Endang'd Flora	Endang'd Fauna	Bushland Corridor Potential	Asset Protection Significance	Bushcare Site
45b	Nelson St.	Gordon	Natural Area	Natural Area	Open Space 6a	Open Space - 6a	Natural Area	No site visit	Not checked	No	Yes - NSt, Vr, Pa & Pp	Yes	No	No
29c	Nerang St.	Wahroonga	Natural Area	Natural Area	Open Space 6a	Open Space - 6a	Natural Area	No site visit	Not checked	No	No	Yes	Yes	Yes
35d	Nimbrin St.	Turramurra	Natural Area & Sports Reserve	Natural Area & Sports Reserve	Road	Open Space - 6a	Natural Area & Sportsground	No site visit	Not checked	No	No	Yes	Yes	No
51b	Northcote Ave	Killara	Technical Services	Natural Area	Road	Open Space - 6a	Natural Area	Yes	STIF T3d	No	No	Yes	Yes	Yes
58b	Ormonde Rd.	Roseville Chase	Natural Area	Natural Area	Open Space 6a	Open Space - 6a	Natural Area	No	Not checked	No	Yes - MSh & Pp	Yes	No	No
19b	Palm St.	St. Ives	Natural Area	Natural Area	Open Space 6a	Open Space - 6a	Natural Area	No site visit	Not checked	No	No	Yes	Yes	No
7d	Phillip Rd	St Ives	Technical Services	Council Wildflower Garden	Road	Open Space - 6a	Natural Area	Fire trail	Sydney Sandstone Ridgetop L3c	No	No	Yes	Yes	No
61c	Primula St.	Lindfield	Natural Area	Natural Area	Open Space 6a	Open Space - 6a	Natural Area	No site visit	Not checked	No	No	Yes	No	No
64b & 65a	Refer to Bradfield Rd.	West Lindfield	Natural Area	National Park, Naamaroo Conference Centre	Open Space 6a	Open Space - 6a	Natural Area	No site visit	Not checked	Yes - Db	Yes - Nc & Pa	No	Yes	No
13b	Refer to Dalton Rd 2.	St Ives	Natural Area	Natural Area	Open Space 6a	Open Space - 6a	Natural Area	No site visit	Not checked	No	No	Yes	No	No
12b	Refer to Milton Rd	North Turramurra	Natural Area	Urban Park & Private Open Space	Road	Open Space - 6a	Natural Area	No site visit	Not checked	No	No	Yes	Yes	Yes
3d	Refer to Murrua Rd	North Turramurra	Natural Area	National Park	Open Space 6a	Open Space - 6a	Natural Area	Fire Break	Not checked	Yes - Db	No	Yes	Yes	No
22d	Refer to Roland Ave.	Warrawee	Urban Park	Residential	Open Space 6a	Open Space - 6a	Park	Yes	Not checked	No	No	Yes	No	No
34b	Refer to Western end of Yanilla Ave.	Wahroonga	Natural Area	Sports Reserve	Open Space 6a	Open Space - 6a	Natural Area	No	Not checked	Yes - Db	No	Yes	Yes	No

Attachment 1.
Unmade Roads across the Ku-ring-gai Local Government Area. Review June 2004

KMAP Ref.	Road Name or Ref.	Suburb	Current Land Use Type & or Manager	Adjoining Land Manager	Current Zoning	Recommended Zoning	Recommended Future Land Use Type & or Manager	Is it an Informal Road or other Structure	Vegetation Association	Endang'd Flora	Endang'd Fauna	Bushland Corridor Potential	Asset Protection Significance	Bushcare Site
35a	Riverview Ave.	Wahroonga	Natural Area	Natural Area & SAOS	Open Space 6a & Road - County Proposed	Open Space - 6a	Natural Area	No site visit	Not checked	Yes - Db	Yes - Pa	Yes	No	No
35a	Roland Ave end of Gipps Close	Turramurra	Natural Area & Sports Reserve	Natural Area & Sports Reserve	Open Space 6a	Open Space - 6a	Natural Area	No site visit	Not checked	No	No	Yes	Yes	No
29d	Roland Ave.	Wahroonga	Natural Area	Natural Area & Sports Reserve	Open Space 6a	Open Space - 6a	Natural Area	No site visit	Not checked	Yes - Tg	Yes - MSh	No	No	No
45d	Rosebery Rd.	Killara	Technical Services	Natural Area	Road	Open Space - 6a	Natural Area	Concrete Steps	Sydney Sandstone Gully M3e	No	Yes - Pp & NSt	Yes	No	Yes
32c	Rosedale Rd. 1.	Pymble	Technical Services	Natural Area	Road	Open Space - 6a	Natural Area	No	Not Currently Mapped - Originally STIF T3d	No	No	Yes	Yes	Yes
38a	Rosedale Rd. 2.	Pymble	Natural Area	Natural Area	Open Space 6a	Open Space - 6a	Natural Area	No site visit	Not checked	No	No	Yes	Yes	No
42c	Saddington St.	Turramurra	Technical Services	Natural Area	Road	Open Space - 6a	Natural Area	No	Sydney Sandstone Ridgetop L2a	No	No	No	Yes	No
52b	Salisbury Rd.	East Killara	Natural Area & National Park	National Park	Open Space 6a	Open Space - 6a	Natural Area	No site visit	Not checked	No	No	Yes	Yes	No
61c	Somerset Rd.	Lindfield	Natural Area	Natural Area, National Park	Road	Open Space - 6a	Natural Area	No site visit	Not checked	No	No	Yes	No	No
52b	Springdale Ave.	East Killara	Technical Services	Natural Area	Road	Open Space - 6a	Natural Area	No	STIF M3c & Sydney Sandstone Gully M3e	No	No	Yes	Yes	No
35a	Tarook Ave.	Turramurra	Natural Area	Natural Area	Open Space 6a	Open Space - 6a	Natural Area	No site visit	Not checked	No	No	Yes	No	No

Attachment 1.
Highways Roadways across the Murrumbidgee Local Government Area. Review June 2004

MMAP Ref	Proposed Name of Rd	Suburb	Current Land Use Type & Manager	Adjoining Land Manager	Current Zoning	Recommended Future Zoning	Recommended Future Land Use Type & Manager	Is it an Informal Road or other Structure?	Vegetation Condition	Endang'd Flora	Endang'd Fauna	Bushland Condition Refuted?	Asset Protection Significance	Bushland Site
45a	Taylor St. 1.	Gordon	Natural Area	Flying Fox Reserve	Road	Open Space - 6a	Natural Area	No site visit	Not checked	No	Yes - Pp	Yes	Yes	No
38d	Taylor St. 2.	Gordon	Natural Area	Natural Area	Open Space 6a	Open Space - 6a	Natural Area	No site visit	Not checked	No	No	Yes	Yes	Yes
55a	Terrace Rd.	Killara	Urban Park	National Park	Road	Open Space - 6a	Park	No site visit	Not checked	Yes - Db	No	Yes	Yes	No
8c	Timbarra Rd	St Ives	Technical Services	Council Wildflower Garden	Road	Road	Technical Services	Yes	Not checked	No	No	Yes	Yes	No
19b	Toolang St.	St. Ives	Natural Area	Natural Area	Open Space 6a	Open Space - 6a	Natural Area	No	Not checked	No	No	Yes	Yes	Yes
53a	Tryon Rd. 1.	East Lindfield	Technical Services	SAOS, Scout Lease, Sports Res, Nat Park	Road	Open Space - 6a	Natural Area	No	Sydney Sandstone Ridgetop M2a	No	No	Yes	Yes	No
57a	Tryon Rd. 2.	Lindfield	Technical Services	Natural Area	Road	Open Space - 6a	Natural Area	Yes	Sydney Sandstone Gully M3e	No	No	No	Yes	No
13b	Refer To Dalton Rd 2.	St Ives	Natural Area	Natural Area	Open Space 6a	Open Space - 6a	Natural Area	No site visit	Not checked	No	No	Yes	No	No
42c	Vernon St.	Turramurra	Natural Area	Natural Area	Open Space 6a	Open Space - 6a	Natural Area	No	Not checked	No	Yes - Cf	No	Yes	No
49a	Wallalong Cres.	Pymble	Natural Area	Natural Area	Open Space 6a	Open Space - 6a	Natural Area	No site visit	Not checked	Yes - Db	Yes - NSt, Vr, Pa & Pp	Yes	Yes	Yes
45b	Warandoo St. 1.	Gordon	Natural Area	Natural Area	Open Space 6a	Open Space - 6a	Natural Area	No site visit	Not checked	No	Yes - NSt, Vr, Pa & Pp	Yes	No	Yes
45b	Warandoo St. 2.	Gordon	Sports Reserve	Sports Reserve	Open Space 6a	Open Space - 6a	Sportsground	No site visit	Not checked	No	Yes - NSt, Vr, Pa & Pp	No	No	No
35c	Warner Ave.	Turramurra	Technical Services	Residential	Road - County Proposed	Open Space - 6a	Technical Services Road	No	Sydney Sandstone Ridgetop L2a	No	No	Yes	No	No

Attachment 1.
Unmade Roads across the Ku-ring-gai Local Government Area. Review June 2004

KMAP Ref.	Road Name or Ref.	Suburb	Current Land Use Type & or Manager	Adjoining Land Manager	Current Zoning	Recommended Zoning	Recommended Future Land Use Type & or Manager	Is it an Informal Road or other Structure	Vegetation Association	Endang'd Flora	Endang'd Fauna	Bushland Corridor Potential	Asset Protection Significance	Bushcare Site
17b	Water St.	Wahroonga	Technical Services	Natural Area	Road	Open Space - 6a	Natural Area	Concrete Pathway	Blue Gum High Forest T3a	No	No	Yes	Yes	No
53a	Wellington Rd.	East Lindfield	Technical Services	Natural Area	Road - Open Space - 6a	Open Space - 6a	Natural Area	No	Sydney Sandstone Ridgeway L3d & Sydney Sandstone Gully M3e	No	No	Yes	Yes	Yes
23b	Wolsten Ave.	Turrumurra	Natural Area	Natural Area & Sports Reserve	Open Space 6a	Open Space - 6a	Natural Area	Yes	Blue Gum High Forest T3a	No	No	No	No	No
55a	Wyuna Rd.	West Pymble	Natural Area	Natural Area	Open Space 6a	Open Space - 6a	Natural Area	No site visit	Not checked	No	No	Yes	No	No
34b	Yanilla Ave.	Wahroonga	Natural Area & Sports Reserve	Natural Area & Sports Reserve	Open Space 6a	Open Space - 6a	Natural Area & Sportsground	Yes	Not checked	Yes - Md	No	No	No	No

Attachment 2
Unmade Roads across the Ku-ring-gai Local Government Area, Priority List June 2004

Road Name or Ref.	Suburb	Priority	Natural area (20)	Endang'd Flora (10)	Endang'd Fauna (10)	Bushland Corridor Potential (10)	Asset Protection Significance (10)	Bushcare (15)
Wallalong Cres.	Pymble	75	20	10	10	10	10	15
Between Ravenhill Rd & ComenarraParkway	Turramurra	65	20		10	10	10	15
Leuna Ave.	Wahroonga	60	20	10	10	10	10	
Warandoo St 1	Gordon	55	20		10	10		15
Toolang St	St Ives	55	20			10	10	15
Timor St. 2.	Gordon	55	20			10	10	15
Refer to Milton Rd	North Turramurra	55	20			10	10	15
Nerang St.	Wahroonga	55				10	10	15
Kissing Point Rd.	Turramurra	55		10	10	10	10	15
Beaumont Rd.	Killara	55				10	10	15
Taylor St. 1.	Gordon	50			10	10	10	
Riverview Ave.	Wahroonga	50		10	10	10		
Refer to Western end of Vanilla Ave.	Wahroonga	50	20	10		10	10	
Refer to Murrue Rd	North Turramurra	50	20	10	10		10	
Refer Bradfield Rd.	West Lindfield	50	20	10	10		10	
Aline St.	Killara	50	20	10	10	10		
Kimo St.	Roseville	45			10	10	10	15
Canoon Rd.	Turramurra	45	15	10		10	10	
Vernon St.	Turramurra	40	20		10		10	
Terrace Rd.	Killars	40	10	10		10	10	
Salisbury Rd.	East Killars	40	20			10	10	
Rosedale Rd. 2.	Pymble	40	20			10	10	
Roland Ave.	Wahroonga	40	20	10	10			
Palm St.	St Ives	40	20			10	10	
Ormonde Rd.	Roseville Chase	40	20		10	10		
Nelson St.	Gordon	40	20		10	10		
Davidson Pde.	Roseville Chase	40	20			10	10	
Dalton Rd 3.	St Ives	40	20			10	10	
Cooper Cres.	Wahroonga	40	20			10	10	
Bushlands Ave.	Killars	40	20			10	10	
Browns Rd	Wahroonga	40	20			10	10	
Beltana Place	Wahroonga	40	20			10	10	
Aleta Close	Wahroonga	40	20	10			10	
Wellington Rd.	East Lindfield	35				10	10	15
Rosedale R d 1	Pymble	35				10	10	15
Rosebery Rd.	Killara	35			10	10		15
Roland Ave end of Gipps Close	Turramurra	35	15			10	10	
Northcote Ave	Killara	35				10	10	15
Nimbrin St.	Turramurra	35	15			10	10	
Mutama St.	Wahroonga	35				10	10	15
Wyuna_ Rd	West Pymble	30	20			10		
Refer to Dalton Rd 2.	St Ives	30	20			10		
Tarook Ave.	Turramurra	30	20			10		
Somerset Rd.	Lindfield	30	20			10		
Primula St..	Lindfield	30	20			10		
Kitchener St	St Ives	30	20			10		
Field of Mars Ave.	Wahroonga	30	20			10		
Crown Ave.	Turramurra	30	20			10		
Between Leuna Ave & Vanilla Ave.	Wahroonga	30	20			10		

Attachment 2
Unmade Roads across the Ku-ring-gai Local Government Area, Priority List June 2004

Road Name or Ref.	Suburb	Priority	Natural area (20)	Endang'd Flora (10)	Endang'd Fauna (10)	Bushland Corridor Potential (10)	Asset Protection Significance (10)	Bushcare (15)
Allara Ave.	North Turramurra	30	20				10	
Vanilla Ave.	Wahroonga	25	15	10				
Kalang Pde.	Wahroonga	25				10		15
Wolsten Ave.	Turramurra	20	20					
Water St.	Wahroonga	Y0				10	10	
Warandoo St 2.	Gordon	20	10		10			
Tryon Rd. 1.	East Lindfield	20				10	10	
Timbarra Rd	St Ives	20				10	10	
Springdale Ave.	East Killara	20				10	10	
Refer to Roland Ave.	Warrawee	20	10			10		
Phillip Rd	St Ives	20				10	10	
Minns Rd.	Gordon	20			10	10		
Malkin End	Gordon	20				10	10	
Hall St.	Turramurra	20			10	10		
Eucalyptus Close	Pymble	20				10	10	
Coonanbarra Rd	North Wahroonga	20				10	10	
Burraneer Ave.	St Ives	20				10	10	
Boundary St. 4.	Roseville	20				10	10	
Boundary St. 3.	Roseville	20				10	10	
Boundary St. 2.	Roseville	20				10	10	
Boundary St. 1.	Roseville	20				10	10	
Boundary Rd. 2.	North	20	10			10	10	
Borambill St.	Warrawee	20				10	10	
Ayres Rd 2.	St. Ives	20				10	10	
Ayres Rd 1.	St. Ives	20				10	10	
Falrlight Ave.	East Killara	15				10	10	15
Warner Ave.	Turramurra	10				10		
Tryon Rd. 2.	Lindfield	10					10	
Saddington St.	Turramurra	10					10	
Near Eastern end of Wambool Rd. 2.	Turramurra	10				10		
Near Eastern end of Warragal Rd. 1.	Turramurra	10				10		
Morris Ave	North Wahroonga	10				10		
Moona Pde.	Wahroonga	10				10		
Montah Ave	Killara	10					10	
Holford Cres. 1.	Gordon	10				10		
Flinders Ave.	St Ives	10				10		
Endeavour St.	North Wahroonga	10				10		
Dalton Rd 1.	St Ives	10		10				
Curagul Rd	North Turramurra	10	10					
Cunliffe Rd.	Killara	10				10		
Cliff Ave	North Wahroonga	10	10					
Chase Ave.	Roseville Chase	10			10			
Carrington Rd	North	10					10	
Boundary Rd 3.	North Wahroonga	10					10	
Boundary Rd 1.	North Wahroonga	10					10	
Bertrand Rd	North Turramurra	10	10					
Attunga Rd.	Roseville Chase	10				10		
Alice St.	Turramurra	10	0			10		
Laurence Ave.	Turramurra	0						
Calga St.	Roseville	0						

DEPUTY MAYORAL TERM - 2004/2005

EXECUTIVE SUMMARY

PURPOSE OF REPORT:	To give consideration to setting the date for the election of the Deputy Mayor or an extension of the Term of Office until September 2005.
BACKGROUND:	The Local Government Amendment (Mayoral Elections) Act extends the term of office of the Mayor until September 2005 but not the Deputy Mayor.
COMMENTS:	<p>Council could extend the Term of Office of the Deputy Mayor or hold an election to fill the position.</p> <p>Traditionally, Council has held this election on the first or second Tuesday in September.</p>
RECOMMENDATION:	That the 2004/2005 election of the Deputy Mayor be held at the Ordinary Meeting of Council on Tuesday, 7 September 2004.

PURPOSE OF REPORT

To give consideration to setting the date for the election of the Deputy Mayor or an extension of the Term of Office until September 2005.

BACKGROUND

Council elected the Mayor and Deputy Mayor in April for the period ending September 2004.

However, the Local Government Act has been amended by the Local Government Amendment (Mayoral Elections) Act 2004 to extend the term of the Mayor until September 2005. The legislation did not include any extension for the current Deputy Mayoral term.

COMMENTS

The Department of Local Government Circular (No 04/35) advises that it is a discretionary matter for Councils to decide whether or not to extend the term of office of the Deputy Mayor to September 2005 or to elect a new Deputy Mayor in September 2004.

Nevertheless, Council did resolve on 13 April 2004 that the current Deputy Mayoral term be until September 2004. It will require a subsequent Council resolution to vary this.

Should Council decide to hold an election for the position then Council will need to determine the meeting in September 2004 at which the election of the Deputy Mayor is to be held.

Traditionally, Council has held this election on the first or second Tuesday in September. It should also be noted that the third Tuesday of the month, there is no Council meeting and the fourth Tuesday falls within the school holiday period.

CONSULTATION

Not applicable.

FINANCIAL CONSIDERATIONS

Not applicable.

CONSULTATION WITH OTHER COUNCIL DEPARTMENTS

Not applicable.

SUMMARY

Not applicable.

RECOMMENDATION

That the 2004/2005 election of the Deputy Mayor be held at the Ordinary Meeting of Council on Tuesday, 7 September 2004.

Geoff O'Rourke
SENIOR GOVERNANCE OFFICER

Brian Bell
General Manager

NATIONAL GENERAL ASSEMBLY OF LOCAL GOVERNMENT 2004

EXECUTIVE SUMMARY

PURPOSE OF REPORT:	For Council to determine its elected delegates to the 2004 National General Assembly of Local Government.
BACKGROUND:	The annual National General Assembly of Local Government will be held in Canberra from Sunday, 7 to Wednesday, 10 November 2004.
COMMENTS:	Each Council is encouraged to send more than one delegate so they can be represented in all concurrent sessions of interest. Council is invited to submit motions. Motions are required to be submitted by 10 September 2004.
RECOMMENDATION:	That Council determines if it wishes to send delegates or submit motions for debate at the 2004 National General Assembly of Local Government.

PURPOSE OF REPORT

For Council to determine its elected delegates to the 2004 National General Assembly of Local Government.

BACKGROUND

The annual National General Assembly of Local Government will be held in Canberra from Sunday 7, to Wednesday, 10 November 2004.

COMMENTS

Council is entitled to send one voting delegate to each concurrent session and submit motions. Deadline for submission of motions to the Australian Local Government Association is 10 September 2004.

CONSULTATION

Not applicable.

FINANCIAL CONSIDERATIONS

Costs: Registration: \$725.00 (early bird – payment received by 20 September 2004)
\$825.00 (standard – payment received by 25 October 2004)
Accommodation and sundries will be extra.

There is sufficient allocation in the budget to meet the costs of attendance at this Conference.

CONSULTATION WITH OTHER COUNCIL DEPARTMENTS

Not applicable.

SUMMARY

Not applicable.

RECOMMENDATION

- A. That Council determines if it wishes to send delegates to the 2004 National General Assembly of Local Government.
- B. That Council determines if it wishes to submit Motions for debate at the 2004 National General assembly of Local Government.

Brian Bell
General Manager

Attachments: Registration Details and Program



2004 National General Assembly of Local Government
7-10 November 2004

Program and Registration



President's Message

2004 is shaping up as a year of unprecedented opportunity for local government in Australia.

The year has already seen the commitment of a further \$1.2 billion to local government through the renewal of the Roads to Recovery program. Local government elections in NSW and Queensland have stirred strong interest in the critical role councils play in the Australian federation. There has been growing focus on the need to progress the Fair Share report on cost shifting and local government financing. And with a federal election due this year, the major parties have—at the national level—been keen to explore ways in which they can embrace local government and work in partnership with us to address issues of mutual concern.

At the time of writing, there is mounting evidence to support the view that we have a once in a generation opportunity to shape and drive long-term change for local government.

We have a genuine opportunity to secure a stronger constitutional base for our activities, to achieve true recognition and engagement as an equal partner in the federal system and to put councils across the country on a more sustainable and solid financial footing.

These objectives will not be easy to achieve and may take time to accomplish. But it is surely time to seize the moment and drive the push for real and meaningful change.

At last year's General Assembly, we witnessed the release of the *Fair Share* report. This year, we need to review progress, to take stock and assess where we are heading and what courses of action will best achieve the changes that will deliver the outcomes our communities want and need.

So, make a difference. Join us for the 2004 National General Assembly of Local Government. Help seize the moment and shape our future.



A stylized, handwritten signature in black ink, appearing to read 'Mike Montgomery'.

Councillor Mike Montgomery
ALGA PRESIDENT



Communities

The 2004 National General Assembly of Local Government will focus on the emerging opportunities for Australian local government to drive and achieve its vision for sustainable and successful communities, from our city centres to our central deserts.

Sustainability has three key elements: economic sustainability to ensure financial resources and capacity necessary to provide services; social sustainability to maintain important community values, such as culture and lifestyles; and finally, environmental sustainability for continued use and enjoyment of natural resources. For local government, political, financial and constitutional sustainability, is critical.

To create sustainable communities, local government needs to be treated as an equal partner within the Australian federation, be constitutionally recognised as such, and have access to a fair share of the nation's financial resources.

Each of the key drivers of local government sustainability will be explored in depth. In particular, delegates will examine important political developments that have occurred since the 2003 General Assembly—including responses to the Fair share report on cost shifting and local government financing—and the impact these may have on the development of a secure economic base to sustain local government into the future.

One of Australia's leading political analysts, Professor Dean Jaensch, will provide a fresh assessment of the opportunities that exist for constitutional recognition. Future directions for local government will be explored, with three perspectives given by Dr Rosemary Kiss of the Centre for Public Policy at Melbourne University, author Matthew Reilly and Mayor Joy Leishman, Caboolture Shire Council, Queensland.



Vision Opportunity

Political opportunities in the months and years ahead will be examined by two of Australia's most senior political insiders, Grahame Morris and Bob Hogg when they look at the post-election landscape.

Social sustainability will feature in the keynote address of Dr Hugh Mackay, the nation's best known social researcher, writer and psychologist.

Concurrent symposiums will focus on:

- Population and demographic issues, from youth to ageing strategies;
- Options for future transport sustainability; and
- Environmental, planning and development issues.

In this, the *Year of the Built Environment*, the *Regional Co-operation and Development Forum*, held in conjunction with the General Assembly, has been themed *Infrastructure: Foundations; for our Future*. The *State of the Regions Report 2004-05*, to be launched at the Forum by ALGA and National Economics, will focus on infrastructure resourcing and the impact of infrastructure on regional development patterns and prospects.

The core work of the General Assembly-debate and determination of-council motions-will again focus on four key themes-local government financing, population and ageing, environment and infrastructure.

2004 is a year of opportunity for local government. So, seize the moment and help define our collective future through your participation at the 2004 National General Assembly of Local Government.



National General Assembly **20**
of Local Government **04**

Awards

National Awards for Innovation in Local Government 2003

Since 1986 the Federal Government has been recognising, celebrating and promoting innovation, excellence and leading practice in local government. The winners of the 2004 Awards will be announced at an invitation only dinner on Sunday 7 November 2004.



Australian Government

Department of Transport and
Regional Services

The Heart Foundation Kellogg Local Government Awards Tuesday 9 November 2004

These awards give recognition to councils working with their communities to encourage healthier lifestyles. The Awards celebrate the important role that local government has in fostering the health of their communities. The awards will be presented during lunch on Tuesday 9 November 2004.



ICLEI Breakfast

Sustainability in Action: The Local Agenda

International Council for Local Environmental Initiatives (ICLEI)
Recognition Event and Breakfast

Monday 8 November, 7:15-8:30 am

The event will recognise councils in ICLEI campaigns and their work to achieve sustainable outcomes for their communities. Invitations will be sent to all ICLEI member and participant councils during September.

Councils not currently involved with ICLEI, but wishing to find out more about the organisation and its work are welcome to attend for a breakfast fee. Seats are limited and must be reserved in advance.

For further information about this event contact ICLEI on:
Phone (03) 9639 8688.

ICLEI
International Council for
Local Environmental Initiatives

20 National General Assembly
04 of Local Government

Key dates

SUBMISSION FOR MOTIONS
FOR DEBATE
10 September 2004

 EARLY BIRD
REGISTRATION
On or before Monday 20 September 2004

STANDARD REGISTRATION
On or before Monday 25 October 2004

LATE REGISTRATION
On or after Tuesday 26 October 2004



Motions for Debate

Councils and Regional Organisations of Councils are encouraged to submit motions on issues of national importance for debate. In particular, we are seeking Notices of Motions in the areas of population and ageing, local government financing, environment, and infrastructure.

**Motions should be received by ALGA no later than
Friday 10 September 2004.**

As in previous years, the ALGA Executive will develop composite motions to reduce the total number of motions under consideration. The ALGA Executive reserves the right to vet whether motions are applicable to the Assembly debate.

This year, in response to delegate requests, the structure of debate has been altered to allow greater participation, but retain the time dedicated to debate. Two concurrent sessions have been programmed on Monday 8 November, 2004. The first concurrent debating session will be population and ageing and local government financing; with the second concurrent debating session being environment and infrastructure. In addition, there will be plenary debating sessions on Tuesday and Wednesday.

Voting Procedures

Each Council is entitled to one voting delegate at each concurrent debating session and one voting delegate in each plenary debating session. Councils will need to determine who their voting delegates will be in each case. Councils are encouraged to send at least two delegates so that they can be fully represented in all concurrent debating sessions of interest to them.

The outcomes of voting in the concurrent debating sessions will be summarised by the Chairs of those sessions and will be debated by exception in the plenary debating session beginning on Tuesday. Voting cards will be distributed at the National Convention Centre beginning 9:00 am Sunday 7 November 2004 and throughout registration.

Program*

Sunday 7 November 2004

9:00AM	Registration
9:30am-5.00pm	Regional Co-operation and Development Forum
5:30-7:00pm	Welcoming Reception and Local Government Expo Opening
7:30pm	National Awards for Local Government (by invitation only)

Monday 8 November 2004

7:15-8:30am	ICLEI breakfast (by invitation only - refer page 4)
8:00AM	Registration
9:00am	Opening Ceremony <ul style="list-style-type: none"> • Anthem • Indigenous Welcome • Introduction of the AIGA Executive • President's Address: Cr Mike Montgomery
9:45am	Keynote Address: Professor Dean Jaensch , AO School of Political and International Studies, Flinders University
10:30am	Morning Tea
11:00am	Concurrent Debate on Motions: Option A: Population and Ageing Option B: Local Government Financing
12:30PM	Lunch
1:30pm	Concurrent Debate on Motions Option A: Environment Option B: Infrastructure
3:00PM	Afternoon Tea
3:30pm	Review of National General Assembly: Cr Rae Perry , Chair Review Committee
3:45pm	Local Government Future Directions: Three perspectives <ul style="list-style-type: none"> • Dr Rosemary Kiss, Centre for Public Policy, The University of Melbourne • Matthew Reilly, Author • Mayor Joy Leishman, Caboolture Shire Council, QLD
5:00PM	Close
7:00pm	Monday Night Dinner & Dance: Anzac Hall, Australian War Memorial

Tuesday 9 November 2004

9:00AM	Concurrent Symposiums: Option A: Sustainable Transport Option B: Social Policy: Ageing Strategy Option C: Connecting Local Government Option D: The Fourth R: Radiation Brought to you by Site Management Alliance
10:30AM	Morning Tea
11:30pm	Keynote address: Is the tide turning for communities? Dr Hugh Mackay , Psychologist, social researcher and writer. Proudly supported by Australia Council
12:00PM	Lunch Heart Foundation Kellogg Local Government Awards
1:15pm	Debate on motions in Plenary: Summary of Monday afternoon by Chairs. Outcomes and further debate by exception
3:00PM	Afternoon Tea
3:30pm	Concurrent Symposiums Option A: Participate - Regulate - Facilitate! Proudly supported by Beacon Foundation Option B: Integrated NRM Planning Option C: Planning and Development
5:00PM	Close
7:00pm	General Assembly Dinner, Great Hall Parliament House

Wednesday 10 November 2004

9:00AM	Debate on Motions in Plenary
10:30AM	Morning Tea
11:00am	What's in store for Local Government: the Federal Political Scene 2005 and beyond: <ul style="list-style-type: none"> • Bob Hogg, AO, Issues Management Consultant • Grahame Morris, Partner, Jackson Wells Morris
12:00PM	Closing Ceremony
12:30PM	Lunch
1:30pm	Annual General Meeting
2:30PM	Close

Open House: 8-10 November 2004

Monday	10:30 AM-5:00 PM
Tuesday	9:00 AM-5:00 PM
Wednesday	9:00 AM-12:00 PM

*Subject to change at the discretion of the convenor

National General Assembly **20**
Of Local Government **04**

Speaker Profiles

LEFT TO RIGHT
 Professor Dan Jaensch AO
 Dr Hugh Mackay
 Mr Bob Hogg AO
 Mr Grahame Morris
 Professor Rosemary Kiss
 Mr Matthew Reilly
 Mayor Joy Leishman



PROFESSOR DEAN JAENSCH AO

Dean Jaensch is Professor in the School of Political and International Studies at Flinders University. He is the author and co-author of 25 books and numerous chapters and articles, mainly on Australian politics, including *The Politics of Australia* (MacMillan), *Power Politics: The Australian Party System* (Allen and Unwin) and *The MacMillan Dictionary of Australian Politics* (MacMillan). He is widely involved in public political education and is a regular political commentator and analyst in the Australian media. Professor Jaensch has also carried out numerous consultancies, including for local government, and he is constantly involved with speaking to a wide range of groups and organisations on the topic of Australian politics. He is a Life Member of the Australian Political Studies Association.

DR HUGH MACKAY

Hugh Mackay is a psychologist, social researcher and writer who has made a life-long study of the attitudes and behaviour of the Australian community. He has also written five books in the field of social psychology: *Reinventing Australia*, *The Good Listener*, *Generations*, *Turning Point* and *Media Mania*. His latest book is *Right and Wrong: How to decide for yourself* (Hodder, 2004). Hugh is a graduate of the University of Sydney and Macquarie University and a Fellow of the Australian Psychological Society. In recognition of his pioneering work in social research, he has been awarded honorary doctorates by New South Wales, Macquarie and Charles Sturt universities. He is a regular contributor to newspapers, radio and television, and is the author of four novels: *Little Lies*, *House Guest*, *The Spin* and *Winter Close*.

MR BOB HOGG AO

Bob Hogg has had a long and distinguished career with the Australian Labor Party, serving as ALP National Secretary between 1988 and 1993 and senior adviser to the then Prime Minister, Bob Hawke, in 1983–86. He was Secretary of the Victorian Branch of the ALP in 1976–83 and a consultant to the Victorian Premier in 1986–87. He was Deputy Chairman of the Singleton Group in 1993–98 and is currently an independent consultant in issues management and a columnist for the Australian Financial Review. He is also a director of Australian Health International and the Snowy Hydro Corporation. He was appointed to the Order of Australia in 1995.

MR GRAHAME MORRIS

Grahame Morris, is a partner in the public relations company, Jackson Wells Morris, and is a former Chief of Staff to Prime Minister John Howard and adviser to many other political leaders. He held key positions in federal and state politics for two decades, was involved in many of the significant public policy issues of the last 20 years and has devised and executed election campaigns, communications programs and policy platforms. He is a former Strategic Policy Director for News Ltd, trained journalist and has lectured in political communications as a Myer Fellow at Pennsylvania State University. He is a regular media commentator on issues relating to government and community attitudes.

DR ROSEMARY KISS

Rosemary Kiss is a senior fellow in the Department of Political Science at the University of Melbourne. Her main fields of study have been in the areas of government and public policy. During the 1980s she was employed in the Victorian state public service in policy and program development positions connected with public housing. Her local government experience includes a period as a councillor at the City of Fitzroy (now part of the City of Yarra), over eight years as a member of the Victorian Local Government Grants Commission (the VGC), and appointments to two Good Governance Task Forces. She has also held an Australian Research Council and Municipal Association of Victoria funded post - doctoral fellowship which enabled her to continue her research on Australian local government and to publish papers both here and abroad on democratic governance and the role of local government.

MR MATTHEW REILLY

With over two million books sold worldwide in fifteen languages, Matthew Reilly is a phenomenal success. Born in Sydney in 1974 he studied Law at the University of New South Wales and is the author of *Ice Station*, *Temple*, *Contest*, *Area 7*, *Scarecrow* and the online novel *Hover Car Racer*. Matthew visits Los Angeles three times a year on movie-related business, but still lives in Sydney. He has also directed three short films.

MAYOR JOY LEISHMAN

Caboolture Shire Mayor Joy Leishman is the driving force behind one of the fastest-growing regions in Australia, an area fast becoming known as the lifestyle capital of southeast Queensland. Mayor Leishman is head of the progressive local government authority that boasts an annual budget in excess of \$145 million and a population of 120,000 people, more than half of which arrived in the last 10 years alone. Several national and international companies have shown their confidence in the leadership of Mayor Leishman and the strong local economy by opening for business in the Shire. She is a strong advocate for structured development in the Shire and a firm believer that a commitment to controlled growth will continue to firmly enhance the motto of Caboolture Shire, 'Where Lifestyle Really Counts'. Mayor Leishman has recently started her second term as Mayor after being returned in March 2004. She was previously a divisional councillor for two terms and the first female Deputy Chairman of the Shire. Her extensive community involvement is well regarded throughout the community.

Sustainable Transport

Australia's transport systems are increasingly being forced to compete for scarce public funding. So what can be done to make transport services more sustainable-economically, socially and environmentally? And what is local government's role in this?

Transport sustainability is relevant to all areas of Australia. In cities, 'density' causes problems of congestion, noise and pollution. Is an integrated land use and transport planning framework the answer? How important is travel demand management? In regional and rural areas, 'distance' is the issue. How sustainable are long-distance public transport services; whether rail, coach, air or shipping?

This symposium will feature national experts in transport policy, planning and research. They will debate these issues, providing options for more transport sustainability and suggestions on how local government can influence the development of sustainable transport systems that work for local communities.

Social Policy: Ageing Strategy

Australia faces a significant ageing of its population over the coming decades. This represents important opportunities for local government, as older people make an enormous contribution to local communities; but population ageing has a range of impacts on planning and service delivery, which present challenges for local government.

Many local councils have a strong commitment to population ageing and have developed, or are initiating the development of, local level responses. The next step for local government is to build on these activities. This symposium will explore some of the strategies local government might undertake to address population ageing. The aim is to help local government meet the challenges and take full advantage of the opportunities presented by an ageing population.

Connecting Local Government

During the last three years ALGA and the State Local Government Associations have been implementing Networking the Nation (NTN) funded projects to improve the capacity of local government use of information communication technology (ICT). During this session you will hear about the progress that has been made, and be briefed on the Directional Roadmap for local government use of ICT over the next ten years. The workshop will include:

1. Report on the outcomes of the Networking the Nation funded projects
2. Report on the Directional Roadmap
3. Roundtable discussion of report and implications

The Fourth R: Radiation

Site Management Alliance is concerned with the business of radiation safety at radio communications sites for workers and the community. Most Council sites are likely to be noncompliant with the applicable Australian standard. This session will set out practical and cost effective online solutions to the legal and policy issues raised by decisions from the Australian Communications Authority (ACA) and ARPANSA. It will detail law and policy, process, outcomes and costs.

Site Management Alliance provides online information about radiation safety for the community and also provides training and employment opportunities for local business. They are NATA and ACA accredited. In this session you will see online demonstrations of their software capacity. The issue is occupational health and safety, and you are invited to engage with their solution. For a preview visit the website www.sitemanager.net.au.

Participate -Regulate -Facilitate!

Does your Council have a youth strategy? Do you think you need one? How does your council involve its younger citizens in the decision-making process? How does your council create an environment that encourages youth to stay in the community as participating and positive young citizens? What can your council do to encourage jobs creation and cultural diversity? Speakers at this symposium will investigate these issues and suggest strategies for local government engagement with its younger citizens. It will showcase youth policy initiatives that go beyond the regulation of public space and look at alternatives to negative policies that perceive young people as a problem, rather than a community asset. Included within this session will be a presentation by the Beacon Foundation, showcasing its innovative approach to real job creation for unemployed, local youth. Beacon will detail its current replication projects with four councils across Australia. Delegates attending this symposium will gain information on how their council might develop its own youth strategy that focuses on the real needs of local young citizens.

Integrated NRM Planning

Local government nationally invests in excess of \$2.4 billion annually on environmental services. Local government is a major investor in natural resource management (NRM) and environmental protection across Australia. This symposium will look at local government's role in achieving improved environmental outcomes. It will explore some of the challenges local government is facing and the opportunities provided by national initiatives such as: the National Action Plan for Salinity; The National Heritage Trust; the National Water Initiative and coastal zone management. The session will look at the regional NRM planning processes set up under these initiatives using case studies.

Planning and Development

Community control of planning and development is a fundamental tenet of local democracy. The objective of development assessment processing and planning policy is to ensure high quality built environments that reflect the wishes of the community as a whole. Across Australia there have been numerous recent efforts to reform development and planning policy with significant implications for local government. The Development Assessment Forum (DAF) was formed in 1998 as a national body charged to reach agreement on more effective and streamlined approaches to development assessment and decision making. A consultation program commissioned by DAF has stimulated significant public debate on the merits of current approaches to development assessment. This symposium will explore in more detail the appropriate role of local government in development assessment and current thinking on the future of community planning and the built environment.

Open House Local Government Expo

Do you have a local issue that you want to discuss with your fellow local government colleagues? Have you got a great local solution or innovation that you wish to share with others? Do you find it hard to connect with colleagues from like-Councils when networking at the social functions?

Following its popular and successful introduction in 2003, Open House returns to provide delegates with a networking opportunity where you get to choose what's on the agenda! Open House is an informal program running concurrently with the General Assembly that provides a structured networking opportunity to discuss topics not on the main agenda.

Delegates will have the opportunity to post issues for discussion throughout the General Assembly. A facilitator will be present in the Open House, located in the Local Government Expo, to assist you get your discussion started. There will be a series of 'House Rules' and a relaxed environment to discuss issues without requiring resolutions, as no formal General Assembly outcomes will result from Open House. This is YOUR opportunity to discuss what's happening on your home patch and seek from, or provide advice and assistance to, your fellow local government colleagues regarding your local issues.

Where is Open House?

Open House is located in the Local Government Expo

Open House times

Monday 8 November	10:30 am-5:00 pm
Tuesday 9 November	9:00 am-5:00 pm
Wednesday 10 November	9:00 am-12:00 pm

National General Assembly **20**
of Local Government **04**

Registration Details

General Assembly Registration

General Assembly Registration Fees

EARLY BIRD	\$725.00	Payment received on or before Monday 20 September 2004
STANDARD	\$825.00	Payment received on or before Monday 25 October 2004
LATE	\$925.00	Payment received on or before Tuesday 26 October 2004

General Assembly Registration includes

- Attendance at all General Assembly sessions
- Morning tea, lunch and afternoon tea as per the General Assembly program
- One ticket to the Welcome Drinks, Sunday
- General Assembly satchel and materials
- Complimentary copy of the *State of the Regions Report 2004-05*

Day Registration Fees

MONDAY	8 November 2004	\$400.00
TUESDAY	9 November 2004	\$400.00
WEDNESDAY	10 November 2004	\$250.00

Day Registration Includes

- Attendance at all General Assembly sessions on the day of registration
- Morning tea, lunch and afternoon tea as per the General Assembly program on that day
- General Assembly satchel and materials

Accompanying Partners Registration

Accompanying Partners Registration Fees

Accompanying Partners Registration Fee	\$240.00
--	-----------------

Accompanying Partners Registration includes

- 1 ticket to the Welcome Reception, Sunday
- The Picturesque Lake, Portraits and Petrov full day tour
- Science and Sport full day tour
- Embassy visit half day tour
- Lunch with General Assembly Delegates on Wednesday 10 November

Privacy disclosure

ALGA collects your personal contact information in its role as a peak body for local government. ALGA may disclose your personal contact information to the sponsors of the event for the purposes of commercial business opportunities. If you consent to ALGA using and disclosing your personal contact information in this way, please tick the appropriate box on the registration form.

20 National General Assembly
04 of Local Government

Regional Co-operation and Development

Forum Registration

Regional Co-operation and Development Forum: Sunday 7 November 2004

The Regional Co-operation and Development Forum highlights the *State of the Regions Report 2004-05* prepared by National Economics in conjunction with the Australian Local Government Association. This year, the Forum will focus on *Infrastructure: foundations for our future*. Brendan Gleeson, Professor of Urban Policy and Management, Griffith University, will give the keynote presentation.

NOTE: Attendance at the Forum on Sunday requires a separate registration. Attendance is NOT included in registration to the General Assembly; however, those attending the General Assembly do receive a discount.

Regional Co-operation and Development Forum Registration Fees

General Assembly Delegates Registration Fees	\$150.00
Forum Only Registration Fees	\$300.00

Forum Registration includes

- Attendance at all sessions on Sunday 7 November
- Morning tea, lunch and afternoon tea as per the Forum program
- Forum satchel and materials

Payment Procedures

Payment can be made by:

- Credit card: **Bankcard, MasterCard, Visa** and **American Express**
- Cheque made payable to ALGA
- Electronic Funds Transfer: **BANK:** Commonwealth
BRANCH: Curtin **BSB NO:** 062905 **ACCOUNT NO:** 10097760 NOTE: If paying via EFT you must quote your transaction reference number on the registration form.

Completed registration forms should be returned to:

Conference Co-ordinators Pty Ltd
PO Box 139
CALWELL ACT 2905
Facsimile (02) 6292 9002 Phone (02) 6292 9000
Email confco@austarmetro.com.au

Cancellation Policy

All alterations or cancellations to your registration must be made in writing and will be acknowledged by post, facsimile or email. Notification should be sent to:

Conference Co-ordinators
PO Box 139,
CALWELL ACT 2905
Facsimile (02) 6292 9002
Email confco@austarmetro.com.au

An administration charge of \$88.00 will be made to any participant cancelling before Friday 8 October 2004. Cancellations received on or after Saturday 9 October 2004 will be required to pay full registration fees. However, if you are unable to attend, substitutes are welcome at no additional cost.

By submitting your registration you agree to the terms of the cancellation policy.

Social Functions

Welcome Reception and Exhibition Opening

National Convention Centre
Sunday 7 November 2004
5:30-7:00 pm
No charge for full registered delegates
No charge for registered accompanying partners
\$33.00 per person for day delegates and guests

Buffet Dinner & Dance" Anzac Hall, Australian War

Memorial Monday 8 November 2004
7:00-1:00 pm
\$70.00 per person

G for George the Lancaster bomber of Dam Busters fame has been Fully restored and on display in Anzac Hall at the Australian War Memorial since December 2003. Tonight's dinner will take place within the display area and the Mezzanine overlooking the displays. You could even find yourself dining under the wings of G for George!

A two course buffet barbecue dinner will be served and **beverages are included.**

Coaches will depart all Assembly hotels at approximately 6:45 pm with return shuttles commencing from 10:15 pm.

General Assembly Dinner

Great Hall,
Parliament House
Tuesday 9 November 2004
7:00-11:00 pm
\$110 per person

Tickets to the prestigious General Assembly Annual Dinner at Parliament House are always highly sought after. Due to the size of the Great Hall, places are limited and therefore booking early is highly recommended to ensure your place.

Coaches will depart all Assembly hotels at approximately 6:45 pm with return shuttles commencing from 10:30pm.

Note: Bookings are accepted in order of receipt.

Accompanying Partners Program

The Picturesque Lake, Portraits and Petrov

Monday 8 November 2004

Departing from the Crowe Plaza at 10:30 am, the day will begin with a brief orientation of the Parliamentary triangle and embassy precinct before spending a relaxing couple of hours cruising on Lake Burley Griffin whilst enjoying a buffet lunch.

After lunch you will have time to spend at Old Parliament House which is home to the National Portrait Gallery and will be featuring a special exhibition on Vladamir Petrov the Soviet spy who asked for political asylum 50 years ago on April 5 1954.

Science and Sport Tour

Tuesday 9 November 2004

Departing from the Crowe Plaza at 10:30 am, you will visit the CSIRO Discovery Centre which showcases CSIROs extraordinary achievements in Science and Technology for Australia.

You will then head on to the Australian Institute of Sport for lunch and a tour of the facilities which will be hosted by one of the elite athletes - you may even catch a famous face doing what they do best!

Embassies Tour

Wednesday 10 November 2004

On this half day tour you will visit two of Canberra's most extraordinary embassies, off limits to the public, where you will be hosted by the diplomatic staff and discover the inner workings of diplomatic missions.



Canberra Weather

The weather in November is mild and generally sunny during the day—an average of around 24°C—with the evenings cooling down to an average low of 9°C.

Accommodation

To book your accommodation at the rates listed below complete the appropriate section of the registration form. Bookings are subject to availability and should be made prior to Friday 8 October 2004.

All cancellations or amendments must be made in writing to Conference Co-ordinators and will be acknowledged by facsimile.

Please note your credit card details are required to guarantee your room. Neither Conference Co-ordinators nor the hotel will make any charges against your credit card unless you fail to give seven days notice in writing of your cancellation. Full payment of your account will be required at the time of your departure.

Crowne Plaza Canberra

1 Binara Street, Canberra

The Crowne Plaza is conveniently located within 100 metres of the Convention Centre and only a short walk from Canberra's CBD and main shopping area. Each room contains individual air-conditioning controls, mini bar, full length mirrors, bathrobes and a work desk.

Single/Twin/Double \$180.00 per night

Hyatt Hotel Canberra

Commonwealth Avenue, Canberra

Hyatt Hotel is a five-star hotel that has won multiple awards as the best superior accommodation in Canberra. It is located within the Parliamentary Triangle but has the feel of a country estate. Each classically designed room boasts luxurious marble bathrooms with a spacious bath and shower.

Single/Twin/Double \$245.00 per night

Medina Executive James Court Apartments

Located within the heart of the city, James Court Apartments are the ideal option if you require more space than a standard hotel room. The apartments are fully serviced just like hotel rooms and gym, sauna and heated swimming pool are all on-site.

One Bedroom apartment \$135.00 per night
Two Bedroom apartment \$175.00 per night

Waldorf Apartment

2 Akuna Street, Canberra

The Waldorf offers four-star fully serviced apartment accommodation only five minutes walk from the National Convention Centre. Each room type contains microwaves, baths, air-conditioning, complimentary cable TV, direct dial phones and air-conditioning. The one and two bedroom apartments also have the benefit of a separate lounge area.

Studio \$150.00 per night

Pacific International Apartments

2 Marcus Clarke Street, Canberra

Pacific International offers open-plan fully serviced apartments on the shores of Lake Burley Griffin. The apartments are within walking distance from the National Convention Centre and Canberra's CBD. Three bedroom apartments are also available, please contact Conference Co-ordinators for details.

Two Bedroom apartment \$181.00 per night

Novotel

65 Northbourne Avenue, Canberra

Located on Canberra's main thoroughfare, the Novotel is a 10--15 minute walk from the National Convention Centre, Canberra's retail district, and West Row cafe precinct. Each room is equipped with iron and ironing board, mini bar, in-room safes and hairdryers.

Single/twin/double \$145.00 per night

Rydges Lakeside Canberra

London Circuit, Canberra

Rydges Lakeside located only a 10--15 minute walk from the National Convention Centre offers spectacular views from all rooms of either the city or Lake Burley Griffin and surrounding mountains. The hotel offers complimentary underground parking to all guests.

Single/twin/double \$142.00 per night

Saville Park Suites

84 Northbourne Avenue, Canberra

Saville offers you the choice of either a hotel style room or one bedroom apartment. Both room types contain a mini bar, tea and coffee making facilities with twin or king size beds. Guests also have access to the hotel's indoor pool, sauna, spa and gymnasium.

Hotel room \$142.00 per night

One bedroom suite \$173.00 per night

Olims Canberra Hotel

Corner of Limestone and Ainslie Avenues

Olims Canberra Hotel offers guests ample parking areas, 24-hour reception, room and laundry services. A central courtyard with fountain, lawns and landscaped gardens is a feature of the heritage hotel.

Single/twin/double \$107.00 per night

Airline Travel

Corporate Travel Management (CTM) has been appointed the official travel agency for the National General Assembly. CTM offers special flexible/changeable General Assembly airfares at up to 40% discount in economy class on Qantas services or the best internet or published airfares available on Qantas and Virgin Blue Airlines. Early booking is advised.

To ensure the BEST possible airfare available, delegates are urged to contact CTM on TOLLFREE: 1800630 866 or Email: groups@travelctm.com and quote the Conference Code 'ALGA 04' when making their travel booking.

Conference fare: Qantas is proud to offer their support to the National General Assembly with a special discount of up to 40% off the FULL economy fare (excluding taxes). The General Assembly fare is flexible and fully refundable with no cancellation fee up until 72 hours prior to departure.

Discount fares: Delegates may prefer to take advantage of the best internet OJO published airfares. Promotional fares are often more affordable than the General Assembly fare. However, they do have conditions attached. Most are non-refundable if cancelled. Travel insurance is strongly recommended.

CTM will advise the best fare availability and conditions of purchase at the time of making your booking.

Coach Transfers

On Arrival: Sunday 7 November 2004

Coach transfers will be provided between the Airport Terminal and General Assembly Hotels (those listed in this brochure) on Sunday 7 November between 7:30 am and 10:00 pm. Coaches will depart from the long term car park and leave approximately every half hour.

**Welcome Reception and Exhibition Opening:
Sunday 7 November 2004**

Coaches will collect delegates from all General Assembly hotels (except Crowne Plaza Canberra) at approximately 5:45 pm. The return coaches will depart at 7:30 pm.

National Awards for Local Government

A shuttle service will be provided for delegates attending the National Award for Local Government dinner. Buses will depart from the National Convention Centre and all General Assembly hotels.

Daily Shuttles to and from the National Convention Centre

A shuttle service between all General Assembly hotels (except Crowne Plaza Canberra) and the National Convention Centre will operate between 8:00 am and 8:45 am. Return shuttles will depart the National Convention Centre at 5:30 pm.

**Buffet Dinner & Dance at the Australian War Memorial:
Monday 8 November**

Coaches will collect delegates from all General Assembly hotels (including Crowne Plaza Canberra) at approximately 6:45 pm. A return shuttle service will operate between 10:30 pm and 11:00 pm.

**General Assembly Annual Dinner, Parliament House:
Tuesday 9 November**

Coaches will collect delegates from all General Assembly hotels (including Crowne Plaza Canberra) at approximately 6:40 pm. A return shuttle service will operate between 10:30 pm

**20 National General Assembly
04 of Local Government**

Registration Form

2004 NATIONAL GENERAL ASSEMBLY OF AUSTRALIAN LOCAL GOVERNMENT
National Convention Centre, 7-10 November 2004 Australian Local Government Association ABN 31 008 613 678

For more than one delegate please photocopy

Register online at www.alga.asn.au
or download PDF, or return this form to:

Conference Co-ordinators
PO Box 139 SALWELL ACT 2905
Phone (02) 6292 9000 Fax (02) 6292 9002
Email conloc@alga.asn.au

By submitting your registration you agree to the
terms and conditions of the cancellation policy

PERSONAL DETAILS

TITLE	NAME	SURNAME
(Delete/Type/Other)		
POSITION		
COUNCIL/ORGANISATION		
ADDRESS		
SUBURB	STATE	POSTCODE
MOBILE	PHONE	FAX
EMAIL	NAME FOR BADGE	

How did you find out about the General Assembly? ☐ ALGA ☐ State/Territory Association ☐ Council ☐ Other:

PRIVACY DISCLOSURE

- ☐ I DO consent to my name appearing in the 2004 General Assembly List of Participants booklet (name, organisation & state only disclosed).
☐ I DO consent to ALGA disclosing my personal contact information as outlined in the privacy disclosure on page 8.

REGISTRATION FEES

GENERAL ASSEMBLY REGISTRATION FEES

PLEASE NOTE registration does NOT include attendance at the Regional Co-operation and Development Forum.

EARLY BIRD Registration Fees (payment received on or before 20 September 2004)		\$725.00	<input type="checkbox"/>
STANDARD Registration Fees (payment received on or before 25 October 2004)		\$825.00	<input type="checkbox"/>
LATE Registration Fees (payment received on or after 26 October 2004)		\$925.00	<input type="checkbox"/>
DAY Registration Fees	Monday 8 November \$400.00 <input type="checkbox"/>	Tuesday 9 November \$400.00 <input type="checkbox"/>	Wednesday 10 November \$250.00 <input type="checkbox"/>

CONCURRENT DEBATE ON MOTIONS Please nominate which session you would be interested in attending (one only)

- MORNING ☐ Option A: Population and Ageing ☐ Option B: Local Government Financing
AFTERNOON ☐ Option A: Environment ☐ Option B: Infrastructure

SYMPOSIA Please nominate which session you would be interested in attending (one only)

- MORNING ☐ Option A: Sustainable Transport ☐ Option B: Social Policy: Ageing Strategy ☐ Option C: Connecting Local Government
☐ Option D: The Fourth R: Radiation
AFTERNOON ☐ Option A: Participate - Regulate - Facilitate ☐ Option B: Integrated NRM Planning ☐ Option C: Planning and Development

REGIONAL CO-OPERATION AND DEVELOPMENT FORUM REGISTRATION FEES

Regional Development Forum only Registration Fee	\$300.00	<input type="checkbox"/>
General Assembly Delegate Registration Fee	\$150.00	<input type="checkbox"/>
State of the Regions Report 2004-05 (Special Regional Forum only Delegates Rate)	\$85.00	<input type="checkbox"/>

Please Note: Full General Assembly registration fee includes complimentary copy of the State of the Regions Report 2004-05

ACCOMPANYING PARTNERS REGISTRATION FEES

Registered accompanying partner's name for lapel badge:	\$240.00	<input type="checkbox"/>
---	----------	--------------------------

SOCIAL FUNCTIONS INCLUDED IN FEES

One ticket to each of the following functions is included in the full General Assembly registration and/or accompanying partners registration fee.
Please confirm if you will be attending by placing a tick in the appropriate boxes. To purchase additional tickets to any of the following functions
please indicate the number required and complete the total amount payable.

REGISTERED DELEGATES AND PARTNERS

Welcome Reception and Exhibition Opening (Sunday 7 November 2004)

I/we will attend: Delegate ☐ Partner ☐ Number of additional tickets @ \$33.00 each Total \$

REGISTERED PARTNERS

The Picturesque Lake, Portraits and Petrov (Monday 8 November 2004)

I will attend: Partner ☐ Number of additional tickets @ \$90.00 each Total \$

Science and Sport (Tuesday 9 November 2004)

I will attend: Partner ☐ Number of additional tickets @ \$70.00 each Total \$

Embassy visit (Wednesday 10 November 2004)

I will attend: Partner ☐ Number of additional tickets @ \$50.00 each Total \$

Registration form continues overleaf

Tickets to these functions are **not included** in conference registration fee or accompanying partners registration fee. To purchase tickets to any of the following functions please indicate the number required and the total amount payable.

Number of tickets @ \$70.00 each Total \$

Number of tickets @ \$110.00 each Total \$

(E.G. DIETARY)

☐ Enclosed is my cheque made payable to ALGA Conference Account

☐ I'm faxing my requirements, payment follows by mail.

☐ I have transacted an Electronic Funds Transfer to the 'ALGA Conference Account'. Transaction reference number

ALGA Account: BANK: Commonwealth BRANCH: Curtin BSB NO: 062905 ACCOUNT NO: 10097760

NOTE: This is a new segment specifically for conference participants only.

☐ Please charge my credit card ☐ BANKCARD ☐ MASTERCARD ☐ VISA ☐ AMEX

CREDIT CARD NUMBER															GRAND TOTAL \$														
--------------------	--	--	--	--	--	--	--	--	--	--	--	--	--	--	----------------	--	--	--	--	--	--	--	--	--	--	--	--	--	--

CARD HOLDER'S NAME

SIGNATURE

EXPIRY DATE / IS THIS A CORPORATE CARD? YES ☐ NO ☐

Please indicate your preference from 1 to 5

Crowne Plaza Canberra \$180 ☐ Single ☐ Twin ☐ Double

Hyatt Hotel Canberra \$245 ☐ Single ☐ Twin ☐ Double

Medina Executive James Court Apartments

1 B/room Apt \$135 ☐ Single ☐ Twin ☐ Double

2 B/room Apt \$175 ☐ Single ☐ Twin ☐ Double

Waldorf Apartments

Studio Room \$150 ☐ Single ☐ Twin ☐ Double

1 B./room-Apt. ... \$172 ☐ Single ☐ Twin ☐ Double

2 B/room Apt • \$222 ☐ Number Sharing _____

Pacific International Apartments

2 Bedroom Apt \$181 ☐ Number Sharing _____

Novotel \$145 ☐ Single ☐ Twin ☐ Double

Rydges Lakeside Canberra

\$142 ☐ Single ☐ Twin ☐ Double

Saville Park Suites

Hotel Room \$142 ☐ Single ☐ Twin ☐ Double

1 B/room Suite \$173 ☐ Single ☐ Twin ☐ Double

Olimp Canberra Hotel \$107 ☐ Single ☐ Twin ☐ Double

Please note your credit card details are required to guarantee your room is held until your noted arrival time. Neither Conference Co-ordinators nor the hotel will make any charges against your credit card unless you fail to give a minimum of seven (7) days notice in writing of your cancellation. All cancellations will be acknowledged in writing by Conference Co-ordinators. Full payment of your account will be required at the time of your departure. The rates quoted are per room per night.

DATE OF ARRIVAL

DATE OF DEPARTURE

SHARING WITH

ESTIMATED TIME OF ARRIVAL

☐ I understand my credit card details are given as a guarantee of my arrival and to ensure my room will be held until my nominated arrival time. No charge for accommodation will be made against this card unless you fail to give a minimum of seven (7) days notice of cancellation in writing to Conference Co-ordinators.

PLEASE CHARGE MY ☐ BANKCARD ☐ MASTERCARD ☐ VISA ☐ AMEX

CREDIT CARD NUMBER

CARD HOLDER'S NAME

SIGNATURE

IS THIS A CORPORATE CARD? YES ☐ NO ☐

Return to Conference Co-ordinators, PO Box 139 CALWELL ACT 2905 or Fax (02) 6292 9002

1234 TO 1274 PACIFIC HIGHWAY AND 1 BEECHWORTH ROAD, PYMBLE - PROPOSED REZONING - ADDITIONAL INFORMATION RECEIVED

EXECUTIVE SUMMARY

PURPOSE OF REPORT:	To provide Council with additional information on the sites 1234-1274 Pacific Highway and 1 Beechworth Road, Pymble, that have previously been considered for rezoning.
BACKGROUND:	Council has requested additional information on the site and a site inspection has been conducted.
COMMENTS:	Additional advice has been obtained on geotechnical, traffic, access and parking.
RECOMMENDATION:	That Council receive and note the information. That Council advise the property owners 1234-1274 Pacific Highway and 1 Beechworth Road, Pymble that any future consideration of these sites for rezoning will only be through the lodgement of a formal rezoning application.

PURPOSE OF REPORT

To provide Council with additional information on the sites 1234-1274 Pacific Highway and 1 Beechworth Road, Pymble, that have previously been considered for rezoning.

BACKGROUND

Council has considered some information on the rezoning of this site on 2 December 2003 and Council requested additional information on 29 June 2004 (**see Attachment A**). Since that date some additional advice has been sought.

COMMENTS

In accordance with Council's resolution dated 2 December 2003 a site inspection was conducted by Councillors and staff on Saturday 26 June 2004 and site access was gained to the rear of No 1252 Pacific Highway, Pymble.

In addition advice has also been obtained by Council for the following matters.

Geotechnical

Council sought the services of Douglas Partners Pty Ltd – Geotechnical, Environment and Groundwater Consultants, to review the geotechnical information for the site (**see Attachment B**). The assessment was based on a review of Council's Environmental Baseline Study (Conacher Travers 2000) and a report by Jeffery & Katauskas Consultants (October 2003). A site inspection was also carried out by the consultant.

Traffic Assessment

Advice has been sought from Council's Strategic Traffic Engineer on the traffic, parking and access issues associated with a potential rezoning of the site, this includes parking and access analysis to/from four points along the block.

Vegetation Communities

At this stage no additional information has been sought by the Planning and Environment Department on the Blue Gum High Forest on the site.

Summary

Council has completed some of the assessment and advice in relation to the potential rezoning of 1234-1274 Pacific Highway and 1 Beechworth Road, Pymble. In addition there is a substantial amount of background information contained in Council's RDS Baseline Studies.

Item 4

S02036
28 July 2004

However, given the focus of staff and resources required to meet the Minister's directions for Stage 2 of the RDS, it is recommended that no further resources be allocated to this task unless a formal rezoning application is received for this area and an appropriate fee paid.

CONSULTATION

There has been no public consultation in respect of this matter.

FINANCIAL CONSIDERATIONS

There has been a cost associated with the engagement of the geotechnical consultants.

CONSULTATION WITH OTHER COUNCIL DEPARTMENTS

There has been some preliminary consultation with Council's Technical Services and Open Space Departments.

SUMMARY

Council has completed some of the assessment and advice in relation to the potential rezoning of 1234-1274 Pacific Highway and 1 Beechworth Road, Pymble. In addition there is a substantial amount of background information contained in Council's RDS Baseline Studies.

However, given the focus of staff and resources required to meet the Minister's directions for Stage 2 of the RDS, it is recommended that the matter be considered further if a formal rezoning application is received.

RECOMMENDATION

- A. That Council receive and note the information.
- B. That Council advise the property owners of 1234-1274 Pacific Highway and 1 Beechworth Road, Pymble Council will not be committing further resources to this matter unless a formal rezoning application is received by Council.

Antony Fabbro
Manager Strategic Planning

Leta Webb
Director Planning & Environment

Attachments: **A - Council resolutions of 2 December 2003 and 29 June 2004.**
 B - Copy of Geotechnical information - Douglas Partners Pty Ltd 16 June 2004.
 C - Memorandum from Strategic Traffic Engineer dated 21 June 2004.

RESOLUTION OF ORDINARY MEETING OF COUNCIL

02 December 2003

1013 **Rezoning Application For The Area Between Beechworth Road Pymble And Warragal Road, Turramurra**

File: S02036

Notice of Motion from Councillor E Malicki dated 26 November 2003.

I move:

- A. That there be a site inspection of this area by Councillors (accompanied by relevant staff) before they are required to make a decision to put this rezoning on exhibition.
- B. That Council obtain independent advice on the following:
 - 1. Traffic impacts of a variety of densities, especially with the suggested access points at Warragal Road and Beechworth Road. Safety of possible access and egress points to the site. Any traffic study needs to include impacts of traffic from PLC Pymble when it has a full school population and the projections of the impacts of the targeted sites in the area, and should also include peak hour and weekend peak traffic.
 - 2. Impacts on the significant blue gums on the site and also adjacent to the sites including the railway corridor and potential impacts on Sheldon Forest.
 - 3. Geotechnical issues as this was raised in Councils initial Environmental Baseline Study.
- C. That baseline studies and any other relevant studies to be given to the consultant.

Resolved:

(Moved: Councillors Malicki/Bennett)

That the above Notice of Motion as amended, be adopted.

For the Resolution: The Mayor, Councillor I Cross, Councillors Bennett, Coleman, Keays, Kitson, Little and Malicki

Against the Resolution: Councillors Hall and Roach

RESOLUTION OF ORDINARY MEETING OF COUNCIL

29 JUNE 2004

318 Sites On Pacific Highway Between Beechworth & Warragal Roads, Pymble - Southern Side

File: S02921

Question Without Notice from Councillor N Ebbeck

Could the General Manager please provide a report to Council in relation to the properties located on the southern side of the Pacific Highway between Beechworth Road and Warragal Road, Pymble and provide information on the potential to re-zone these properties to 2(d3)?

Could you also consider what options are available to Council to allow the applicants to provide the report for re-zoning as part of their application?

Answer by the Mayor

The General Manager will report back.



Ku-ring-gai Council
818 Pacific Highway
GORDON NSW 2072

Attention: Anthony Fabbro
FAX No: 9424 0880

Dear Sirs

**REVIEW OF GEOTECHNICAL INFORMATION
1232 TO 1274 PACIFIC HIGHWAY, PYMBLE**

This letter report was prepared at the request of Council to review and comment on geotechnical information and matters relevant to rezoning of the above site for medium density housing.

In summary, based on a visit to the site by the writer, knowledge of the area, and the information provided, the writer is of the opinion that there are no insurmountable geotechnical problems associated with rezoning of the site for medium density housing.

The site is underlain by the Ashfield Shale formation from within the Wianamatta Group, is moderate to steep with slopes up to about 16 degrees, has numerous tall trees, lawns and gardens on relatively large blocks around one and two storey detached, predominantly brick residences. There were no signs of significant slope instability, although many years ago there have reportedly been minor stability problems in the rail cuttings or embankments.

Development of the site including excavation for construction of a 1 to 3 level basement car park is feasible provided investigation, design and construction are carried out by competent and experienced consultants and contractors using accepted standards and procedures.

Detailed geotechnical investigation would be required prior to any future major development on this site. Investigation should include:

- Preparation of a detailed topographic survey of the site and surrounds including rail cuttings, track embankments and possibly some downslope areas;
- Geotechnical inspection and logging of the railway cuttings and review of their stability and history;
- Cored boreholes in areas of proposed significant loading or excavation across the site, some to below the level of the railway, and some with standpipe piezometers for observations of groundwater levels;
- Testing of rock for strength and soils for reactivity, plasticity and pavement properties;
- Preparation of a geotechnical investigation report containing the results from the field and laboratory work with recommendations for design and construction.

Integrated Practical Solutions



The Association of
Consulting Engineers
Australia

Offices: Sydney, Newcastle, Brisbane, Melbourne, Perth, Wyong, Campbelltown, Townsville, Cairns, Wollongong, Darwin

Principals: K A Boddie, J C Braybrooke, M Y Broise, G Eastwood, J P Harvey, S R Jones, J Lean, A N Lee, R W Lumsdaine, F MacGregor, P McDonald, G W McIntosh, J M Nash, M J Pugh, R Tong, T J Wiesner, A J Wilson, G R Wilson, G S Young

Senior Associates: G S W Eade, G C Hawkins, B W Ims, B J McPherson, G S Marais, I G Ploer, K M Preston, B F Rippingdale, T J Waters

Associates: C R Bell, C Bozinovski, A Castrissios, C M Deegan, M P Gawn, N A Kontos, R K Lloyd, S A McFarlane, D McIntock, D J Martin, D J Millard, A R Murphy, D E Murray, J O Pucci, D L Quallschick, K Schuit, P D Stuart, C J Stewart, M D Wainman, M P Wright

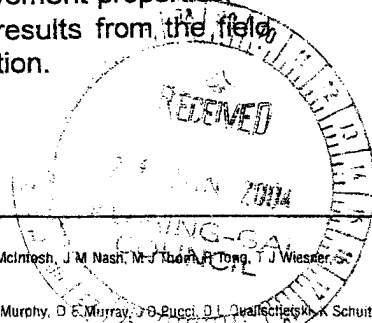

In arriving at this opinion the writer visited the site and read the following documents:

- Jeffery & Katauskas letters dated 27 and 31 October 2003.
- Section 3.1 and 3.2 of the "Environmental Baseline Study" prepared by Conacher Travers Pty Ltd dated December 1999 together with viewing of relevant plans.
- Relevant sections of reports and diagrams provided with your letter dated 14 May 2004.

We trust the above comments are sufficient for your present requirements and are pleased to be of service.

Yours faithfully

DOUGLAS PARTNERS PTY LTD

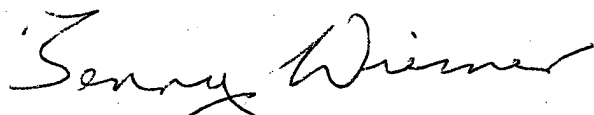
Dr Terry Wiesner
Principal

Reviewed by

for **Dr Fiona MacGregor**
Principal

21 June 2004

MEMORANDUM

TO: DIRECTOR TECHNICAL SERVICES

FROM: STRATEGIC TRAFFIC ENGINEER

SUBJECT: **REZONING APPLICATION FOR THE AREA BETWEEN
BEECHWORTH ROAD PYMBLE AND WARRAGAL ROAD,
TURRAMURRA**

I refer to the area bounded by Beechworth Road, Pacific Highway, Warragal Road and the north shore railway line. This site has an area of about 22,209m² (excluding the nursing home at 1228 Pacific Highway). The northern end of the site is located about 700m from the entrance to Turramurra railway station and the southern end of the site is about 750m from Pymble railway station.

These comments examine traffic aspects of the potential rezoning of the site to permit medium density development.

A floor space ratio of 1:1 was assumed, and the apartment split was considered to be 60% x 3 bedroom and 40% x 2 bedroom, with an average apartment size of 125 m². The potential traffic generation from the site was calculated using the rates in the Roads and Traffic Authority's Guide to Traffic Generating Developments for medium density dwellings.

Two scenarios were examined:

1. The whole site is consolidated into 1 lot, with only 2 access points: 1 on Beechworth Road and 1 on Warragal Road.
2. The site is consolidated into 4 separate lots, loosely based on the current level of site consolidation, 4 access points would be required, 2 of which would be located off Pacific Highway.

The existing site has 20 detached dwellings, which would generate 180 vehicle trips per day (vpd) and 17 vehicles trips per hour (vph, two-way) during the peak hour. Almost all of the existing dwellings have access to Pacific Highway.

Consolidation of Site into 1 Lot

The following table shows the potential result of consolidating the site into 1 lot:

Site Area	Apartment Yield	Daily Traffic Generation (vpd)	Peak Hour Traffic Generation (vph)
22,209 m ²	107 x 3 bedroom 71 x 2 bedroom	1051	106

It was assumed that this traffic generation would be distributed equally between 2 access points, located in Beechworth Road and Warragal Road. Therefore, each access point would carry 53 vehicle trips (two-way) during the peak hour. Assuming that 70% of trips are away from the development during the morning peak 37vph would be leaving each driveway and 16vph would be entering each driveway. This is not a significant traffic generation, and represents 1 vehicle leaving each driveway about every 2 minutes during the morning peak. Vehicles would be entering each driveway at the rate of about 1 every 4 minutes.

If parking was provided at the maximum rate permitted under LEP194, then 285 resident and 45 visitor parking spaces would be required. Each driveway would therefore service 165 car spaces. According to DCP43, Category 2 driveways would be required (combined entry/exit, 6.0m-9.0m wide) at each access point.

AS 2890.1 requires that access driveways be located beyond the influence of normal queue lengths at signalised intersections. Failing this, left in/left out arrangements, signalisation or other traffic management measures must be implemented. A brief inspection was undertaken during the morning peak in Beechworth Road at Pacific Highway and it was observed that the queue lengths in Beechworth Road rarely reached the westernmost end of the Beechworth Road frontage. The existing 'Left Turn on Red' assists in dissipating the left turn queues in Beechworth Road, and the signal phasing appears to be reasonably timed to reduce delays to Beechworth Road traffic. Given this, a median to restrict access to left in/left out (or other traffic control device) may not be required in Beechworth Road.

Consolidation of the Site into 4 Separate Lots

The layout of the 4 separate lots was loosely based on the current level of site consolidation, as portrayed in a report on the transport aspects of the site by consultants Masson Wilson Twiney (27 October 2003). Relatively smaller lots would occur at the extremities of the site, with vehicular access onto Beechworth Road and Warragal Road. The larger lots would be in the middle of the site and would have vehicular access to Pacific Highway. The sketch below shows the potential site consolidation.

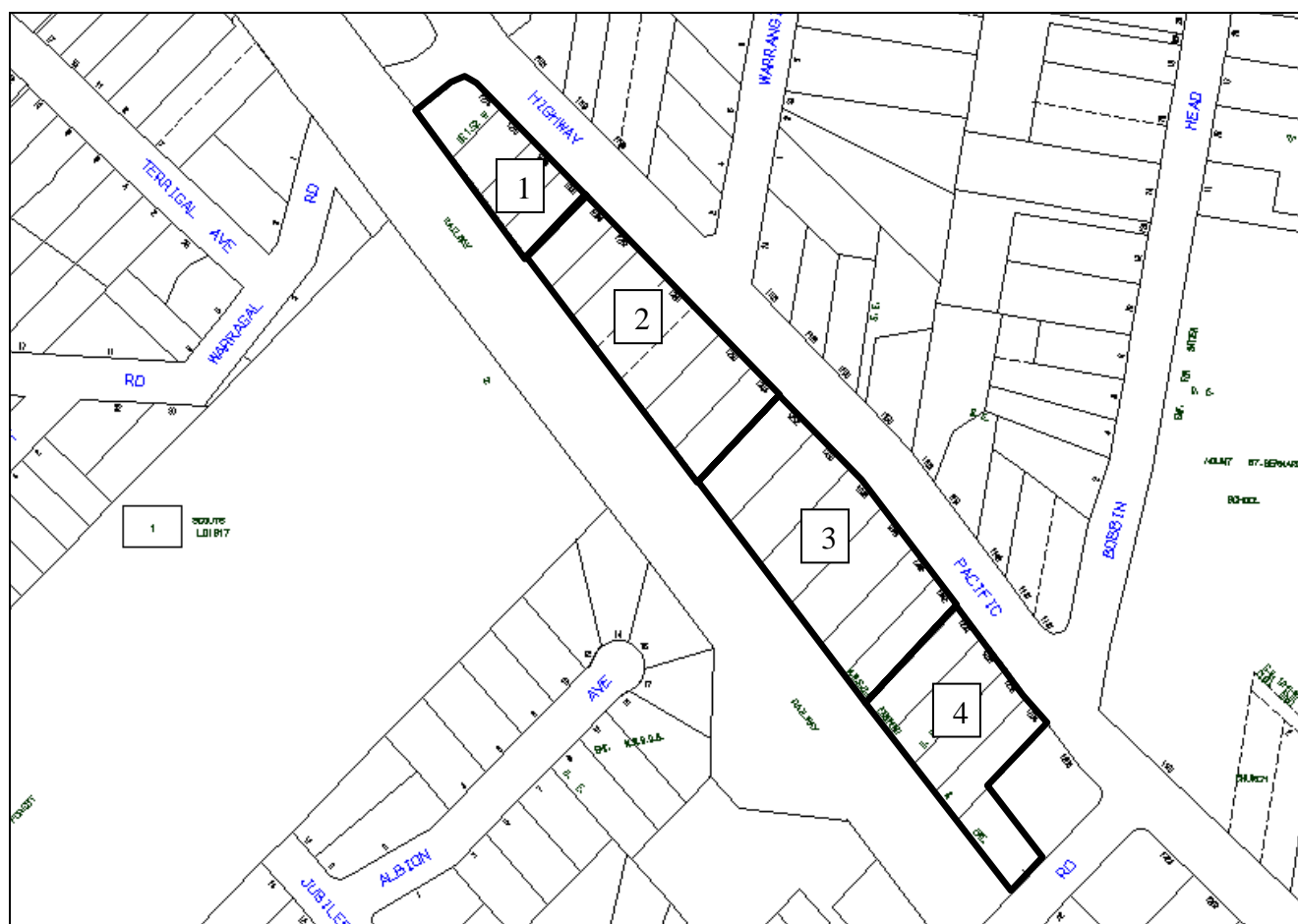

The table below shows potential lot sizes, resulting apartment yields and traffic generation:

Lot	Lot Area	Apartment Yield	Daily Traffic Generation (vpd)	Peak Hour Traffic Generation (vph)
Lot "1" – Corner Pacific Highway and Warragal Road.	2,918 m ²	14 x 3 bedroom 9 x 2 bedroom	136	13
Lot "2" incorporating no.s 1254, 1256, 1258, 1262 and 1264 Pacific Highway.	6,367 m ²	31 x 3 bedroom 20 x 2 bedroom	302	30
Lot "3" incorporating no.s 1242, 1244, 1246, 1248, 1250 and 1252 Pacific Highway.	7,787 m ²	37 x 3 bedroom 25 x 2 bedroom	366	37
Lot "4" – Corner Pacific Highway and Beechworth Road.	5,317 m ²	26 x 3 bedroom 17 x 2 bedroom	254	26

Again, assuming that 70% of trips are away from the development during the morning peak, then 18vp/h would be leaving the Beechworth Road driveway and 8vp/h would be entering the Beechworth Road driveway. This is also not a significant traffic generation, and represents 1 vehicle leaving the driveway about every 3 minutes during the morning peak. Vehicles would be entering the driveway at

the rate of about 1 every 9 minutes. The demand on the Warragal Road access point during the morning peak would be 9vph leaving the driveway and 4vph entering, which is also a very low rate.

Note that this scenario would have ¼ of the impact to Warragal Road traffic flows and ½ the impact to Beechworth Road traffic flows that the former scenario would. This is because the bulk of traffic movements would have access from Pacific Highway, rather than the side streets. There is also no discount for the existing traffic generation, so net traffic generation particularly from Lots “2” and “3” would be lower.

The parking and access requirements for this scenario are detailed in the table below

Lot	Apartment Yield	Parking Requirement	Access Point
Lot “1” – Corner Pacific Highway and Warragal Road.	14 x 3 bedroom 9 x 2 bedroom	37 resident spaces <u>6 visitor spaces</u> 42 spaces total	Category 1 (combined entry/exit, 3.7m-6m wide)
Lot “2” incorporating no.s 1254, 1256, 1258, 1262 and 1264 Pacific Highway.	31 x 3 bedroom 20 x 2 bedroom	82 resident spaces <u>13 visitor spaces</u> 95 spaces total	Category 2 (combined entry/exit, 6m-9m wide)
Lot “3” incorporating no.s 1242, 1244, 1246, 1248, 1250 and 1252 Pacific Highway.	37 x 3 bedroom 25 x 2 bedroom	99 resident spaces <u>16 visitor spaces</u> 115 spaces total	Category 3 (separate entry/exit, 6.0m wide entry, 4m-6m wide exit, 1m-3m separation)
Lot “4” – Corner Pacific Highway and Beechworth Road.	26 x 3 bedroom 17 x 2 bedroom	69 resident spaces <u>11 visitor spaces</u> 80 spaces total	Category 1 (combined entry/exit, 3.7m-6m wide)

Since the number of spaces served by the access point of Lot “2” nears 100, the RTA may require that this be a Category 3 driveway as well. In this scenario, the necessity for a median in Beechworth Road to restrict access to left in/left out may be even less than the previous scenario, due to the reduced demand on Beechworth Road.

Joseph Piccoli
STRATEGIC TRAFFIC ENGINEER

NOTICE OF MOTION

RETAIL CENTRES

Notice of Motion from Councillor L Bennett dated 19 July 2004.

I move:

That a site inspection of Retail Centres be arranged.

RECOMMENDATION

That the above Notice of Motion as printed be adopted.

Cr Laura Bennett
Councillor for St Ives Ward

NOTICE OF MOTION

CLAUSE 251(6) OF LEP 194

Notice of Motion from Councillor L Bennett dated 20 July 2004.

I move:

- A. That a Report be brought to council to consider amending Clause 25I(6) of LEP 194 to allow land adjoining that for medium density to be counted as part of the site (with no change to its zoning status).
- B. That the Report address the following issues:
 - 1. the ability of such a change to minimise the impact of 5 story development on adjoining dwellings in single residential zones.
 - 2. whether the controls in LEP 194 and DCP 55 (including draft controls) would be achievable given an amendment to Clause 25I(6)
 - 3. what negative impacts might result from an amendment to clause 25I(6) including any changes to bulk and scale
 - 4. what the scope of any amendment could be including whether it could be restricted to land zoned for single residential dwellings with street frontage or up to a maximum size
- C. That a map of interface sites that would be affected be prepared.
- D. That funding for implementation be sourced in the first instance from any budgetary surplus in the current financial year to a maximum of \$20,000 and that the Report come to Council no later than September 2004.

RECOMMENDATION

That the above Notice of Motion as printed be adopted.

Cr Laura Bennett
Councillor for St Ives Ward

Cr Ian Cross
Councillor for Wahroonga
Ward

Cr Elaine Malicki
Councillor for Comenarra
Ward