

Annex B Detailed Survey Plans

A-F1
SECTION 1
RAILWAY BRIDGE OVER HAVILAH ROAD
LINDFIELD

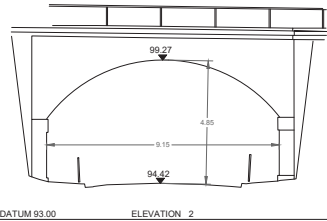

STRUCTURE LOOKING ON ELEVATION 1

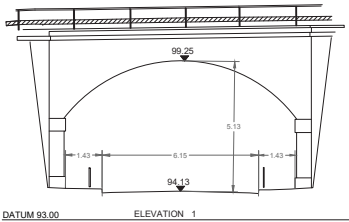
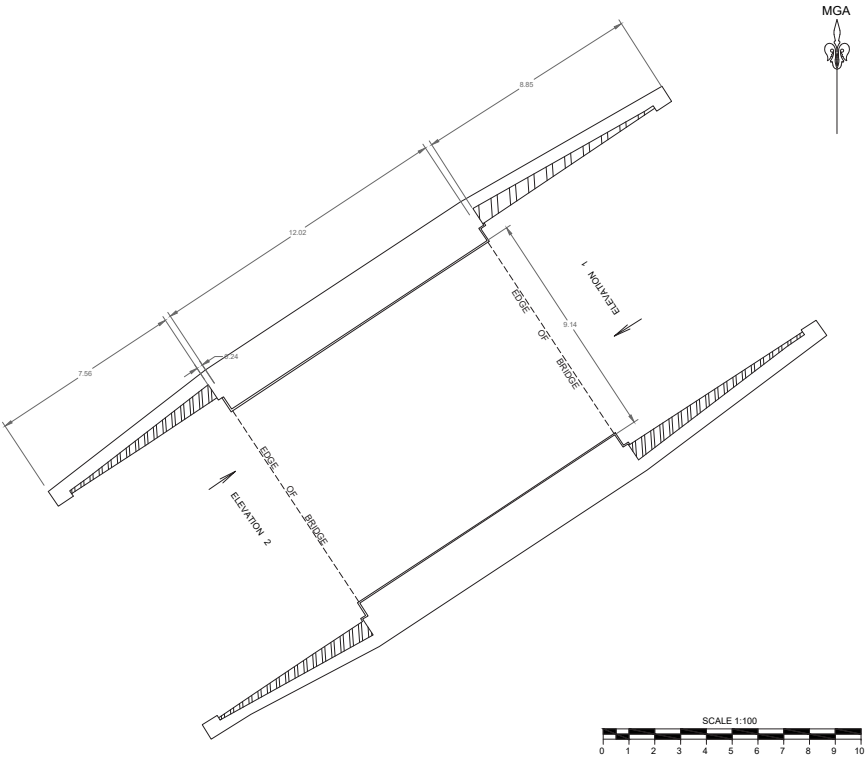

STRUCTURE LOOKING ON ELEVATION 1

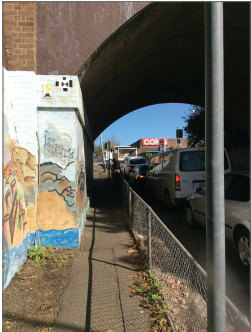

STRUCTURE LOOKING ON ELEVATION 1



STRUCTURE LOOKING ON ELEVATION 2



STRUCTURE LOOKING ON ELEVATION 2

SHEET 1 OF 1

DRAWING No. A-F01

SECTION 1,
UNDER RAILWAY BRIDGE
HAVILAH ROAD, LINDFIELD

© PROJECT SURVEYORS - 2020
REPRODUCTION WITHOUT WRITTEN
APPROVAL IS STRICTLY PROHIBITED

BELLA VISTA

PO Box 7419
BAULKHAM HILLS NSW 2153
SUITE 405, LEVEL 4
14 LEXINGTON DRIVE
BELLA VISTA NSW 2153
PHONE : 9056 1900

email: office@projectsurveyors.com.au
www.projectsurveyors.com.au
ABN 20 068 433 974



SCIMS SURVEY MARK

CAUTION
SURVEY DATA CONTAINED IN THIS FILE IS MGA (GDA94)
IT IS NOT THE MOST CURRENT TRANSFORMATION MGA2020 (GDA2020)
IT IS THE RESPONSIBILITY OF ANY USER OF THIS DATA TO ENSURE ANY
OTHER DATA BEING INTEGRATED IS THE SAME COORDINATE SYSTEM

MGA (GDA94) ORIGIN	SS 169043	E 330541.827	N 6261549.988
MGA ORIENTATION	SS 169043 TO SS 163034	52° 06' 24" - 190.797	
AHD ORIGIN	SS 163045	RL 83.73	CLASS LB

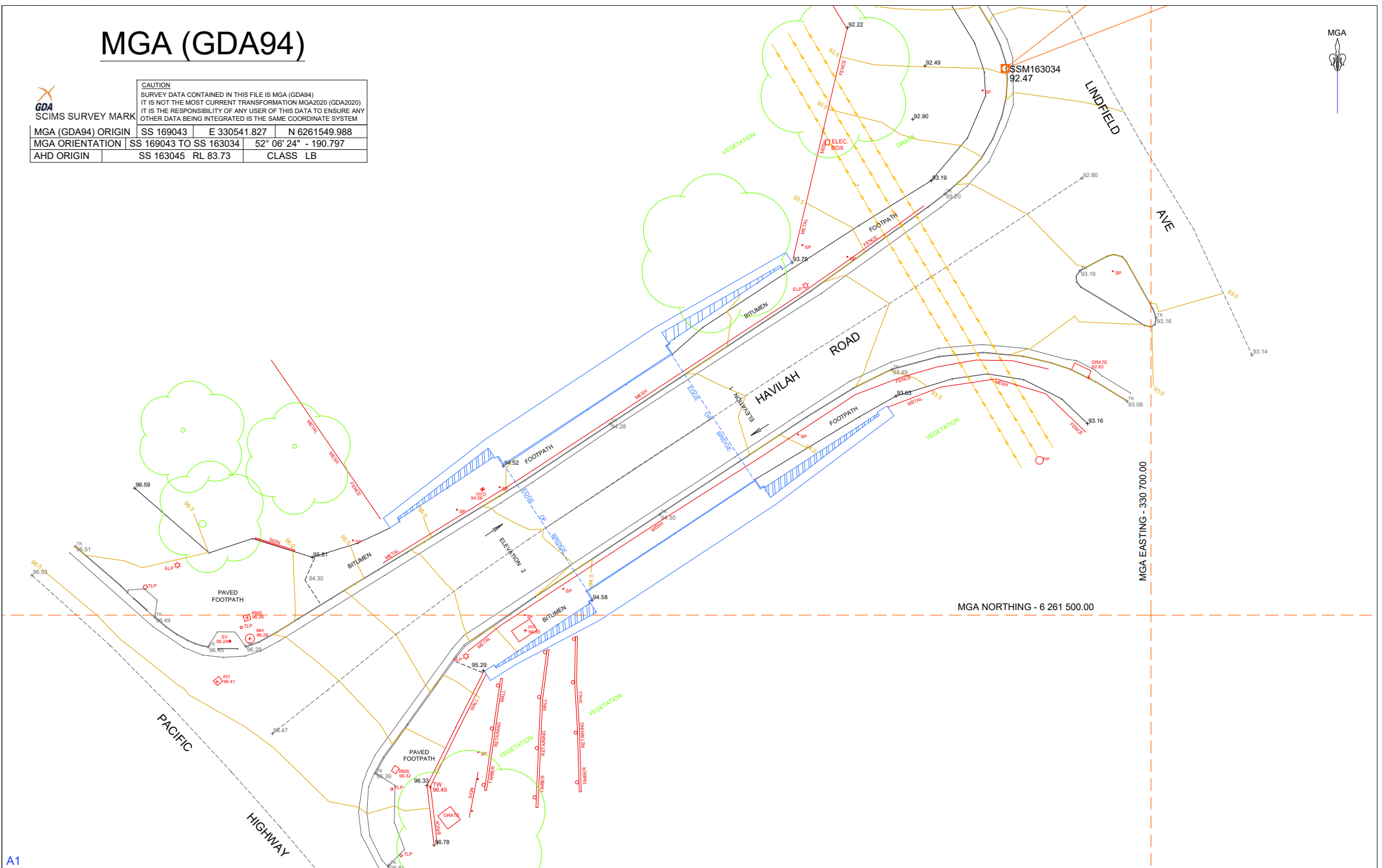

A1

NOTES :

- * BEARINGS RELATE TO MGA NORTH ORIGINATING FROM SCIMS.
* LEVEL DATUM IS ALSO ORIGINATING FROM 163045 RL 83.736.
* VISIBLE, ACCESSIBLE SERVICES ONLY HAVE BEEN LOCATED. THIS PLAN DOES NOT PURPORT TO SHOW UNDERGROUND SERVICES.
* EXISTENCE OF SERVICES NOT BEEN VERIFIED BY CONTACTING DIAL BEFORE YOU DIG (BVDY) 1100.COM AU
* CRITICAL SERVICES MUST BE EXPOSED AND LOCATED
* CONTOURS SHOWN ARE INDICATIVE OF LAND FORM. SPOT LEVELS SHOULD TAKE PRECEDENCE.
* THIS TITLEBLOCK IS AN INTEGRAL PART OF THIS DRAWING AND SHOULD NOT BE REMOVED.

LEGEND

ELP - ELECTRIC LIGHT POLE
HYD - HYDRANT
TW - TOP WALL
TK - TOP KERB
TG - TOP GUTTER
PP - POWER POLE
SMH - SEWER MANHOLE
SP - SIGN POST
SV - STOP VALVE
TEL - TELSTRA PIT
VC - VEHICLE CROSSING
WM - WATER METER



© PROJECT SURVEYORS - 2020
REPRODUCTION WITHOUT WRITTEN
APPROVAL IS STRICTLY PROHIBITED

REV	AMENDMENTS	DATE

CLIENT:	BMT
---------	-----

PLAN OF: SECTION 1,
UNDER RAILWAY BRIDGE
HAMILTON ROAD, UNDEFIELD

SHOWING: GENERAL DETAIL AND
SITE LEVELS

PURPOSE: ARCHITECTURAL
COUNCIL SU
SHEET 1 OF 2

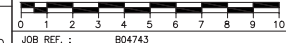

DRAWING No. B04743-DETAIL-SEC1
SURVEYOR: JD
CHECKED: SD
REGISTERED LAND SURVEYOR

DATE: 31/08/2020
DATUM: A.H.D.
ORIGIN: SSM 163045 RL 86.73
REFERENCE SYSTEM: MGA

BELLA VISTA

PO Box 7419
BAULKHAM HILLS NSW 2153
SUITE 405, LEVEL 4
14 LEXINGTON DRIVE
BELLA VISTA NSW 2153

PHONE : 9056 1900
email: office@projectsurveyors.com.au
www.projectsurveyors.com.au
ABN 30 068 433 074



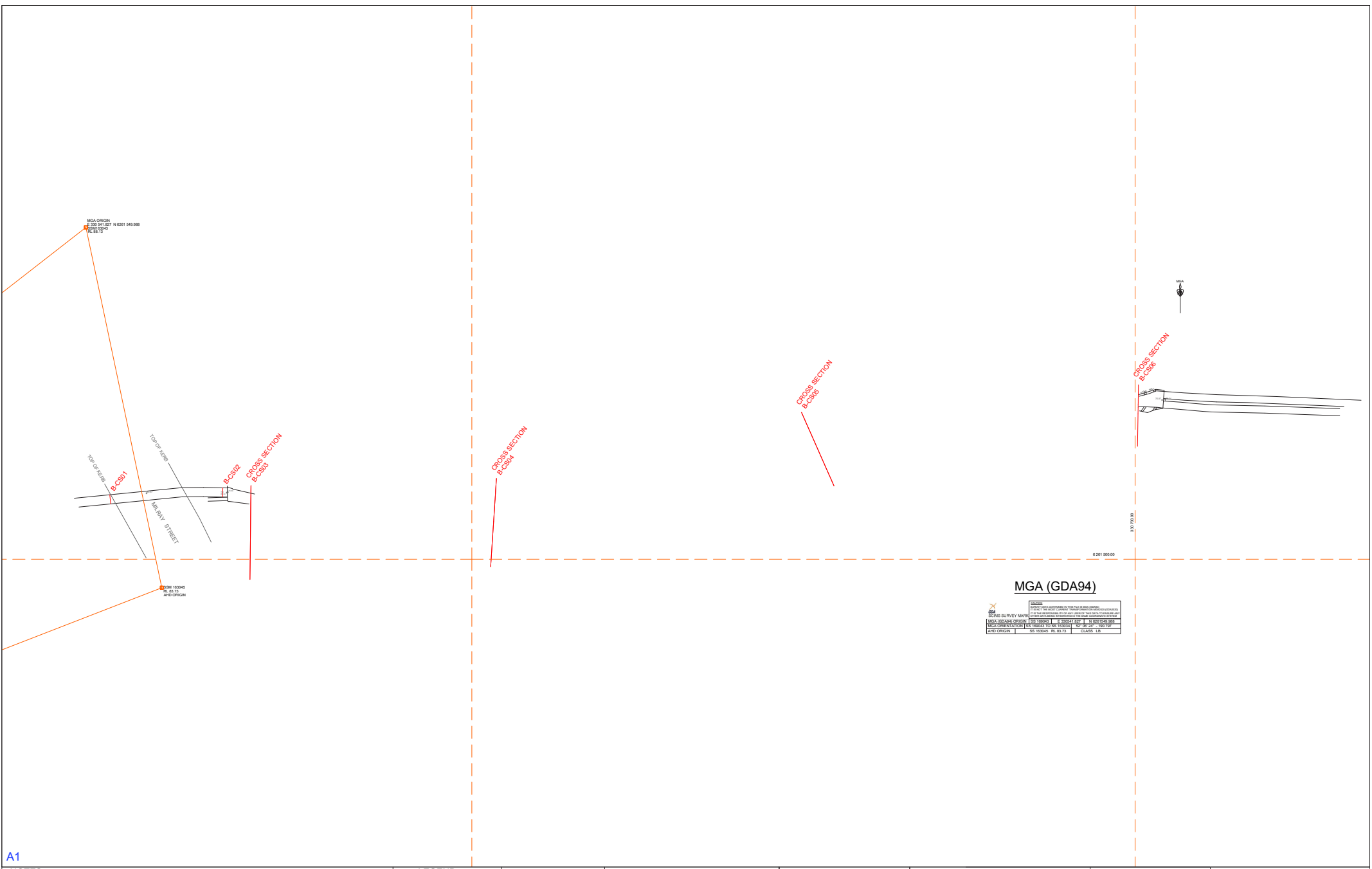

A1

NOTES:

- * BEARINGS RELATE TO MGA NORTH ORIGINATING FROM SCIMS.
- * LEVEL DATUM IS AHD ORIGINATING FROM 163045 RL 83.736.
- * VISIBLE, ACCESSIBLE SERVICES ONLY HAVE BEEN LOCATED. THIS PLAN DOES NOT PURPORT TO SHOW UNDERGROUND SERVICES.
- * THE EXISTENCE OF UNDERGROUND SERVICES HAS NOT BEEN ESTABLISHED.
- * EXISTENCE OF SERVICES MUST BE VERIFIED BY CONTACTING DIAL BEFORE YOU DIG (DBYD) 1100.COM.AU
- * CRITICAL SERVICES MUST BE EXPOSED AND LOCATED
- * CONTOURS SHOWN ARE INDICATIVE OF LAND FORM. SPOT LEVELS SHOULD TAKE PRECEDENCE.
- * THIS TITLEBLOCK IS AN INTEGRAL PART OF THIS DRAWING AND SHOULD NOT BE REMOVED.

LEGEND

ELP - ELECTRIC LIGHT POLE
HYD - HYDRANT
TW - TOP WALL
TK - TOP KERB
TG - TOP GUTTER
PP - POWER POLE
SMH - SEWER MANHOLE
SP - SIGN POST
SV - STOP VALVE
TEL - TELSTRA PIT
VC - VEHICLE CROSSING
WM - WATER METER



© PROJECT SURVEYORS - 2020 REPRODUCTION WITHOUT WRITTEN APPROVAL IS STRICTLY PROHIBITED		
REV	AMENDMENTS	DATE

CLIENT: BMT

PLAN OF: SECTION 2-3,
MILRAY STREET TO
NELSON ROAD, LINDFIELD

SHOWING: GENERAL DETAIL AND
CROSS SECTION LOCATIONS

PURPOSE: ARCHITECTURAL DESIGN
COUNCIL SUBMISSION

SHEET 1 OF 1

SCALE 1:100

0 1 2 3 4 5 6 7 8 9 10

JOB REF. :	B04743
DRAWING No.	B04743-ZoneB
SURVEYOR:	JD
CHECKED:	SD
REGISTERED LAND SURVEYOR	
DATE:	31/08/2020
DATUM:	A.H.D.
ORIGIN:	SSM 163045 RL 86.73
REFERENCE SYSTEM:	MGA

BELLA VISTA

PO Box 7419
BAULKHAM HILLS NSW 2153

SUITE 405, LEVEL 4
14 LEXINGTON DRIVE
BELLA VISTA NSW 2153

PHONE : 9056 1900

email: office@projectsurveyors.com.au
www.projectsurveyors.com.au
ABN 20 058 433 974





STRUCTURE DOWNSTREAM



VIEW LOOKING DOWNSTREAM

PIPES UNDER MILRAY STREET LINDFIELD ID: B-F01

PLAN VIEW

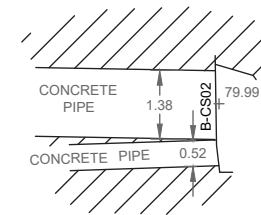

SECTIONS LOOKING DOWNSTREAM

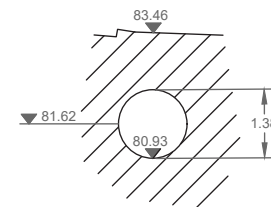

DATUM 79.00

LOCATION B-CS01

SECTION TAKEN UNDER ROAD

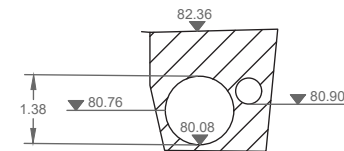

DATUM 79.00

LOCATION B-CS02

SCALE 1:100

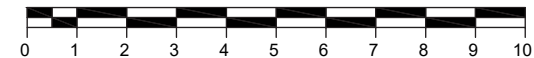

© PROJECT SURVEYORS - 2020
REPRODUCTION WITHOUT WRITTEN
APPROVAL IS STRICTLY PROHIBITED

BELLA VISTA

PO Box 7419
BAULKHAM HILLS NSW 2153

SUITE 405, LEVEL 4
14 LEXINGTON DRIVE
BELLA VISTA NSW 2153

PHONE : 9056 1900
email: office@projectsurveyors.com.au
www.projectsurveyors.com.au
ABN 20 068 433 974



**PROJECT
SURVEYORS**

Professional Innovative... Results.

LINDFIELD ID: B-F02



STRUCTURE DOWNSTREAM

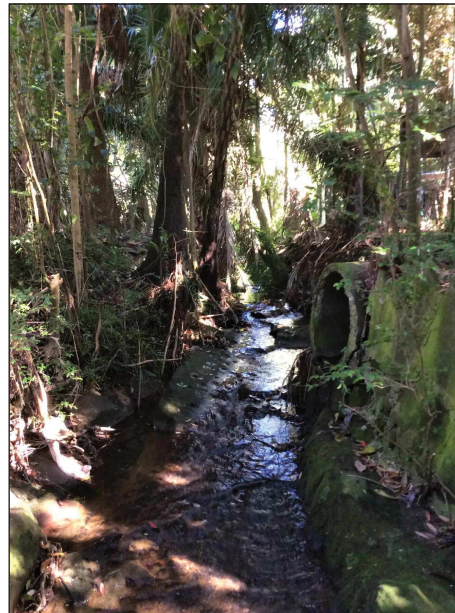

VIEW LOOKING DOWNSTREAM

PLAN VIEW

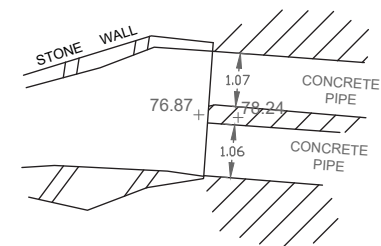

MGA



SECTION LOOKING DOWNSTREAM

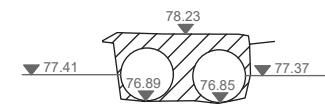

DATUM 76.00

LOCATION B-CS07

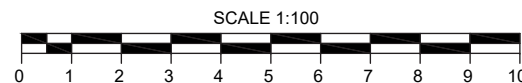

© PROJECT SURVEYORS - 2020
REPRODUCTION WITHOUT WRITTEN
APPROVAL IS STRICTLY PROHIBITED

BELLA VISTA

PO Box 7419
BAULKHAM HILLS NSW 2153

SUITE 405, LEVEL 4
14 LEXINGTON DRIVE
BELLA VISTA NSW 2153

PHONE : 9056 1900

email: office@projectsurveyors.com.au
www.projectsurveyors.com.au

ABN 20 068 433 974



**PROJECT
SURVEYORS**

Professional Innovative... Results.

MGA (GDA94)

SURVEY MARK			
MARK	CLASS	DATE	BY
BM	1	01/08/2020	RL 67.211
DATA ORIGIN	1	01/08/2020	RL 67.211
DATA ORIGIN	1	01/08/2020	RL 67.211
DATA ORIGIN	1	01/08/2020	RL 67.211

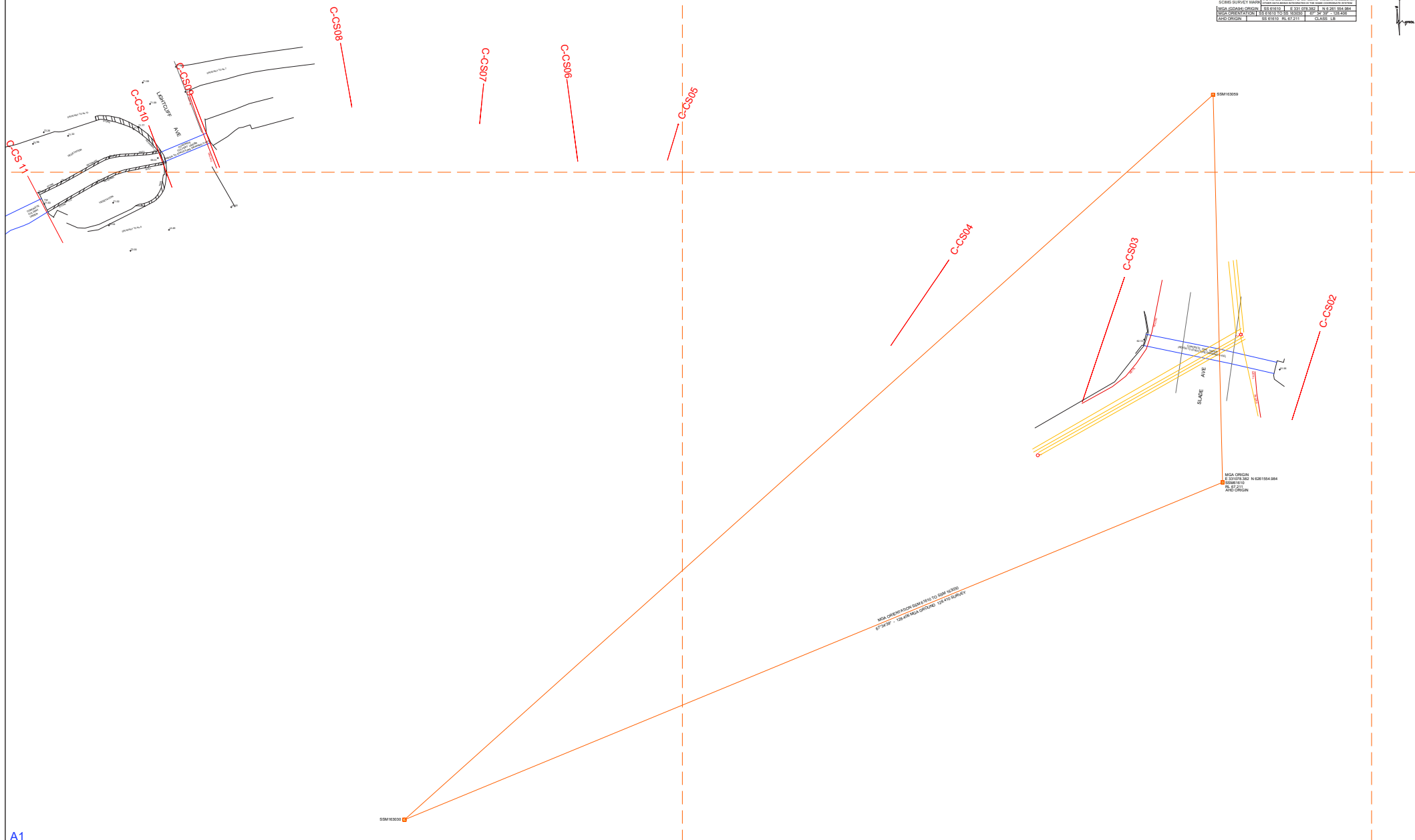

A1

NOTES:

- * BEARINGS RELATE TO MGA NORTH ORIGINATING FROM SCIMS.
- * LEVEL DATUM IS AHD ORIGINATING FROM 61610 RL 67.211
- * VISIBLE, ACCESSIBLE SERVICES ONLY HAVE BEEN LOCATED. THIS PLAN DOES NOT PURPORT TO SHOW UNDERGROUND SERVICES.
- * THE EXISTENCE OF UNDERGROUND SERVICES HAS NOT BEEN ESTABLISHED.
- * EXISTENCE OF SERVICES MUST BE VERIFIED BY CONTACTING DIAL BEFORE YOU DIG (DBYD) 1100.COM.AU
- * CRITICAL SERVICES MUST BE EXPOSED AND LOCATED
- * CONTOURS SHOWN ARE INDICATIVE OF LAND FORM. SPOT LEVELS SHOULD TAKE PRECEDENCE.
- * THIS TITLEBLOCK IS AN INTEGRAL PART OF THIS DRAWING AND SHOULD NOT BE REMOVED.

C-CS01 ——— DENOTES LOCATION OF CROSS SECTION WITHIN ZONE C

LEGEND

ELP - ELECTRIC LIGHT POLE
HYD - HYDRANT
TW - TOP WALL
TK - TOP KERB
TG - TOP GUTTER
PP - POWER POLE
SMH - SEWER MANHOLE
SP - SIGN POST
SV - STOP VALVE
TEL - TELSTRA PIT
VC - VEHICLE CROSSING
WM - WATER METER



© PROJECT SURVEYORS - 2020
REPRODUCTION WITHOUT WRITTEN
APPROVAL IS STRICTLY PROHIBITED

REV	AMENDMENTS	DATE

CLIENT: BMT

PLAN OF: SECTION 4-5,
LIGHTCLIFF AVE TO SLADE
AVE, LINDFIELD

SHOWING: GENERAL DETAIL AND
CROSS SECTIONS LOCATION

PURPOSE: ARCHITECTURAL DESIGN
COUNCIL SUBMISSION

SHEET 1 OF 1

SCALE 1:100

JOB REF. :	B04743
DRAWING No.	B04743-ZoneC
SURVEYOR:	BG & DY
CHECKED:	SD
DATE:	01/08/2020
DATUM:	A.H.D.
ORIGIN:	SSM 61610 RL 67.211
REFERENCE SYSTEM:	MGA

BELLA VISTA

PO Box 7419
BAULKHAM HILLS NSW 2153

SUITE 405, LEVEL 4
14 LEXINGTON DRIVE
BELLA VISTA NSW 2153

PHONE : 9056 1900

email: office@projectsurveyors.com.au
www.projectsurveyors.com.au
ABN 20 084 433 974



CULVERT UNDER LIGHTCLIFF AVE, LINDFIELD ID: C-F01

PLAN VIEW

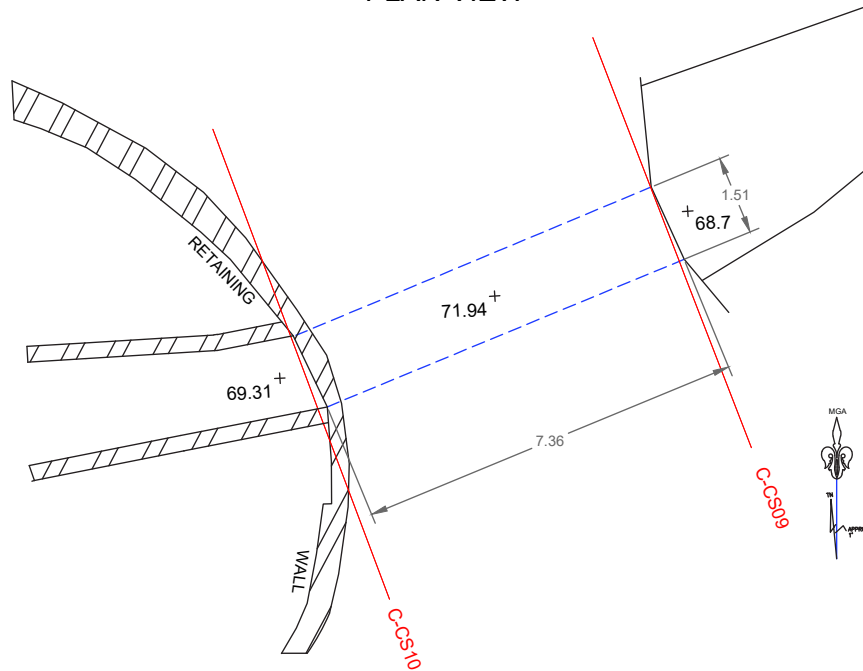

SECTIONS LOOKING DOWNSTREAM

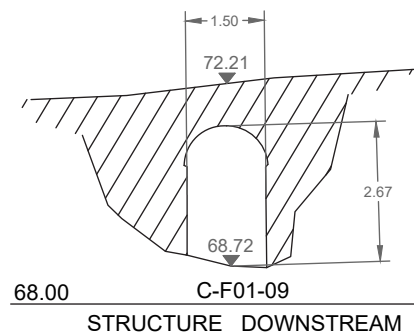
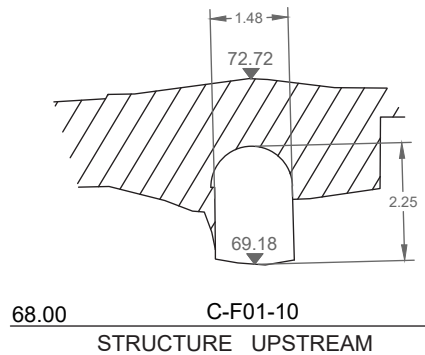

STRUCTURE UPSTREAM



VIEW LOOKING UPSTREAM

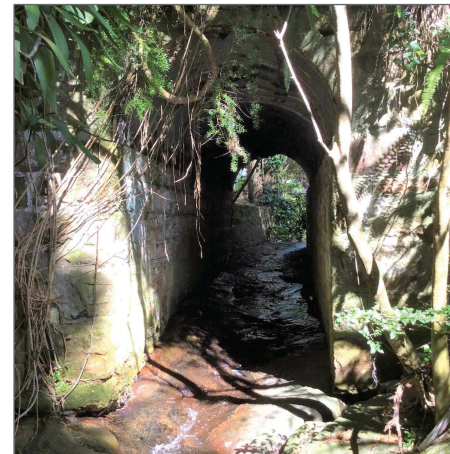

STRUCTURE DOWNSTREAM

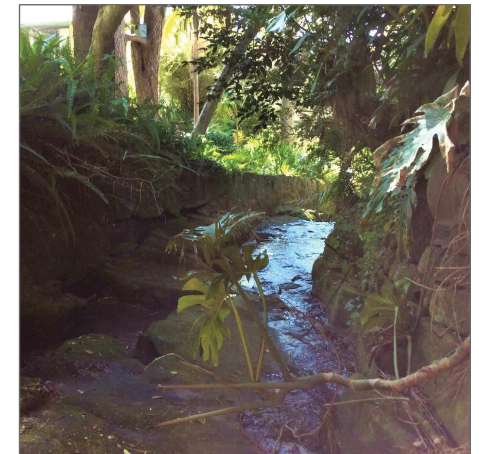

VIEW LOOKING DOWNSTREAM

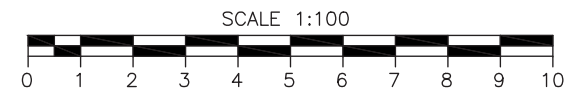

© PROJECT SURVEYORS - 2020
REPRODUCTION WITHOUT WRITTEN
APPROVAL IS STRICTLY PROHIBITED

BELLA VISTA

PO Box 7419
BAULKHAM HILLS NSW 2153

SUITE 405, LEVEL 4
14 LEXINGTON DRIVE
BELLA VISTA NSW 2153

PHONE : 9056 1900

email: office@projectsurveyors.com.au
www.projectsurveyors.com.au

ABN 20 068 433 974



**PROJECT
SURVEYORS**

Professional Innovative... Results.

PIPE UNDER SLADE AVENUE, LINDFIELD

ID: C-F02

PLAN VIEW

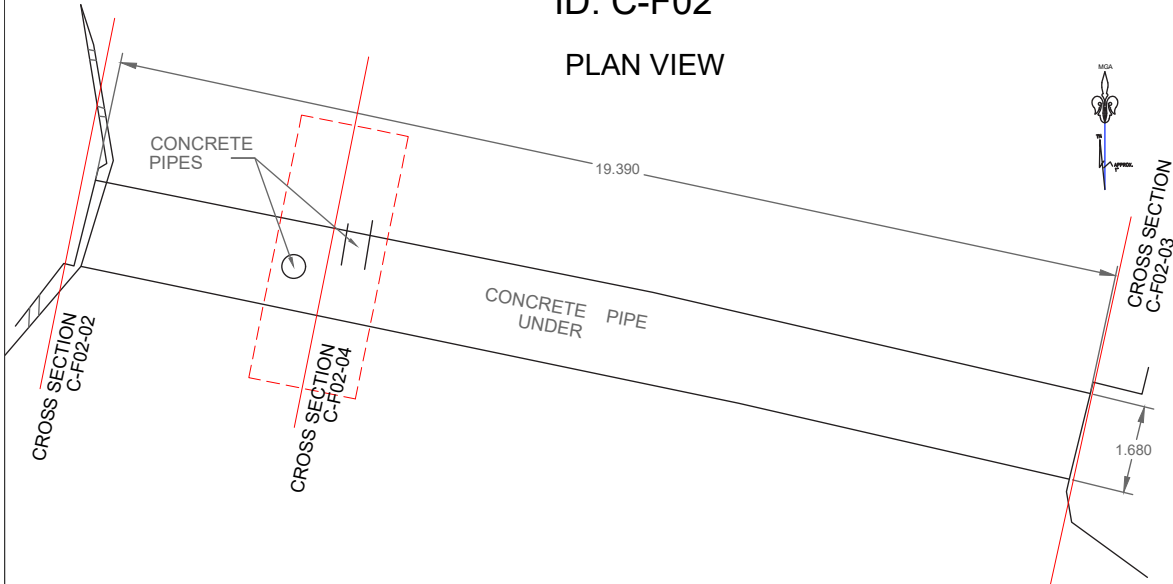

SECTIONS LOOKING DOWNSTREAM

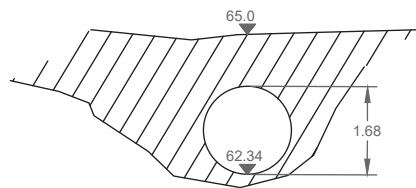

60.00 C-F02-02
UPSTREAM STRUCTURE

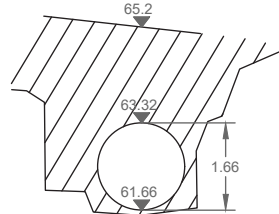

60.00 C-F02-03
DOWNSTREAM STRUCTURE

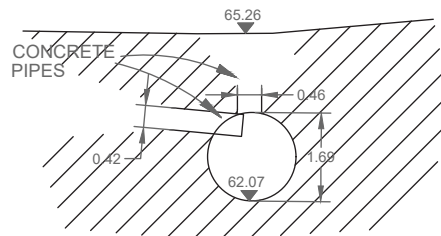

60.00 C-F02-04
UNDER ROAD STRUCTURE



STRUCTURE UPSTREAM

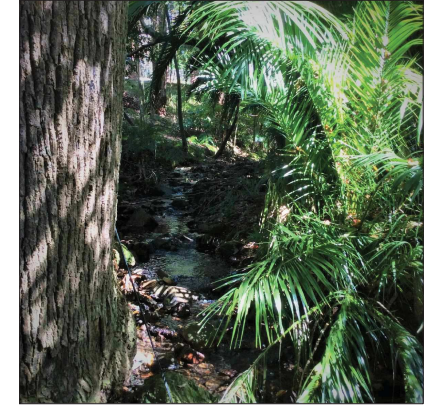

VIEW LOOKING UPSTREAM



STRUCTURE DOWNSTREAM

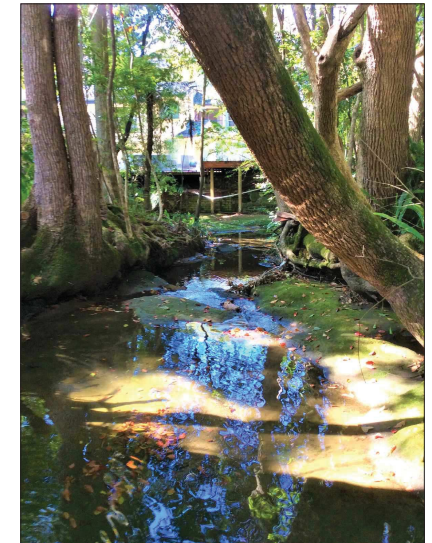

VIEW LOOKING DOWNSTREAM

© PROJECT SURVEYORS - 2020
REPRODUCTION WITHOUT WRITTEN
APPROVAL IS STRICTLY PROHIBITED

BELLA VISTA

PO Box 7419
BAULKHAM HILLS NSW 2153

SUITE 405, LEVEL 4
14 LEXINGTON DRIVE
BELLA VISTA NSW 2153

PHONE : 9056 1900

email: office@projectsurveyors.com.au
www.projectsurveyors.com.au

ABN 20 068 433 974



**PROJECT
SURVEYORS**

Professional Innovative... Results.

A1

NOTES:

- * BEARINGS RELATE TO MGA NORTH ORIGINATING FROM SCIMS.
- * LEVEL DATUM IS AHD ORIGINATING FROM SSM 163020 RL 72.30
- * VISIBLE, ACCESSIBLE SERVICES ONLY HAVE BEEN LOCATED. THIS PLAN DOES NOT PURPORT TO SHOW UNDERGROUND SERVICES.
- * THE EXISTENCE OF UNDERGROUND SERVICES HAS NOT BEEN ESTABLISHED.
- * EXISTENCE OF SERVICES MUST BE VERIFIED BY CONTACTING DIAL BEFORE YOU DIG (DBYD) 1100.COM.AU
- * CRITICAL SERVICES MUST BE EXPOSED AND LOCATED
- * CONTOURS SHOWN ARE INDICATIVE OF LAND FORM. SPOT LEVELS SHOULD TAKE PRECEDENCE.
- * THIS TITLEBLOCK IS AN INTEGRAL PART OF THIS DRAWING AND SHOULD NOT BE REMOVED.

D-CS01 ——— DENOTES LOCATION OF CROSS SECTION WITHIN ZONE D

LEGEND

- ELP - ELECTRIC LIGHT POLE
- HYD - HYDRANT
- TW - TOP WALL
- TK - TOP KERB
- TG - TOP GUTTER
- PP - POWER POLE
- SMH - SEWER MANHOLE
- SP - SIGN POST
- SV - STOP VALVE
- TEL - TELSTRA PIT
- VC - VEHICLE CROSSING
- WM - WATER METER



© PROJECT SURVEYORS - 2020
REPRODUCTION WITHOUT WRITTEN
APPROVAL IS STRICTLY PROHIBITED

REV	AMENDMENTS	DATE

CLIENT: BMT

PLAN OF: SECTION 6-7,
VALLEY RD TO TRYON
RD, LINDFIELD

SHOWING: GENERAL DETAIL AND
CROSS SECTION LOCATIONS
PURPOSE: ARCHITECTURAL DESIGN
COUNCIL SUBMISSION

SHEET 1 OF 1

JOB REF. :	B04743
DRAWING No.	B04743-ZoneC
SURVEYOR:	BG & DY
CHECKED:	SD
DATE:	AUG 2020
DATUM:	A.H.D.
ORIGIN:	SSM 163020 RL 72.30
REFERENCE SYSTEM:	MGA

BELLA VISTA

PO Box 7419
BAULKHAM HILLS NSW 2153
SUITE 405, LEVEL 4
14 LEXINGTON DRIVE
BELLA VISTA NSW 2153
PHONE : 9056 1900
email: office@projectsurveyors.com.au
www.projectsurveyors.com.au
ABN 20 068 433 974



PROJECT
SURVEYORS

Professional Innovative... Results.

CAUTION PROPERTY DATA CONTAINED IN THIS FILE IS MGA (GDA94). IT IS THE RESPONSIBILITY OF ANY USER OF THIS DATA TO ENSURE ANY OTHER DATA BEING INTEGRATED IS THE SAME COORDINATE SYSTEM.			
SCIMS SURVEY MARK			
MGA (GDA94) ORIGIN	SS 61610	E 331 076 382	N 6 201 554 884
MGA ORIENTATION	SS 61610 TO SS 163020	67° 34' 30"	128.406
ANG ORIGIN	SSM 163020 RL 72.30	CLASIS	LB



CULVERT UNDER VALLEY ROAD ID: D-F01

PLAN VIEW

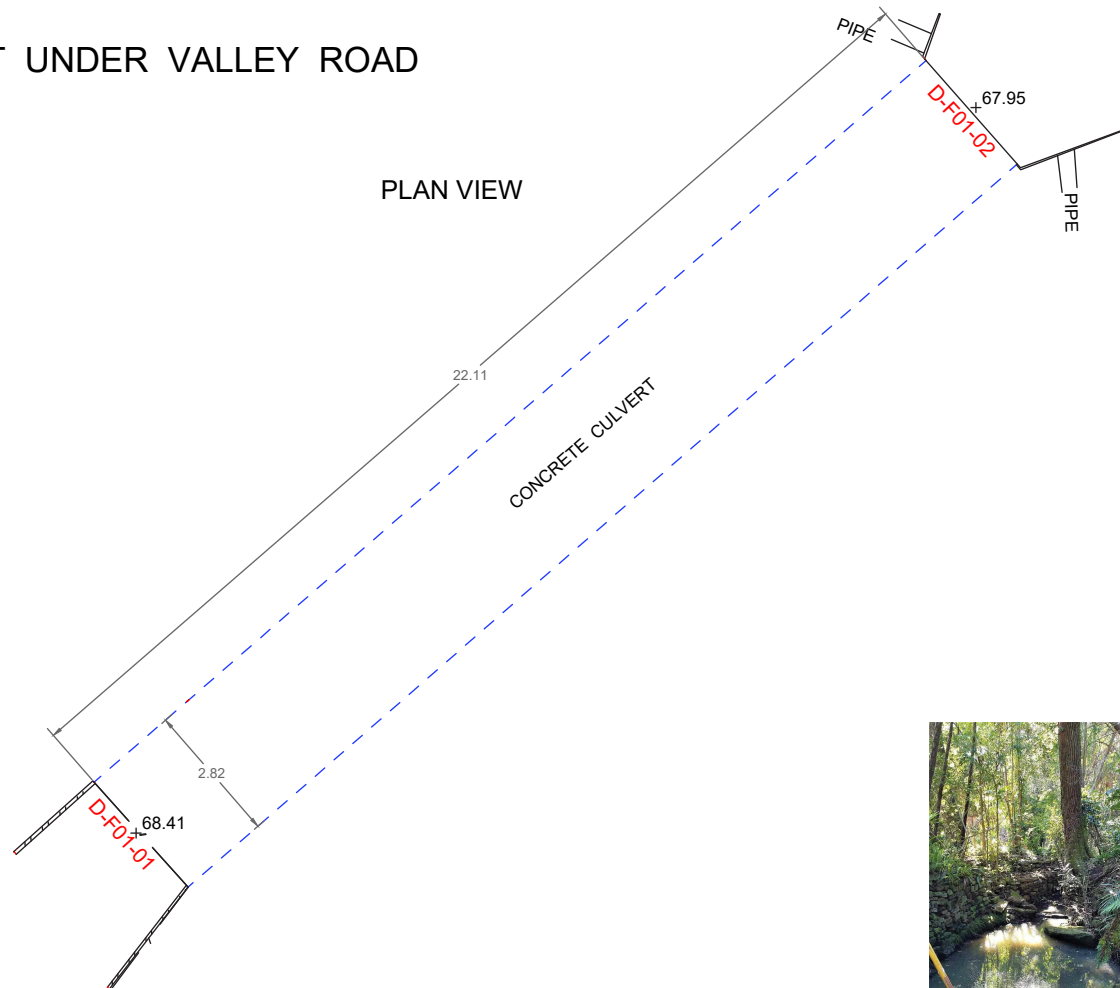

SECTIONS LOOKING DOWNSTREAM

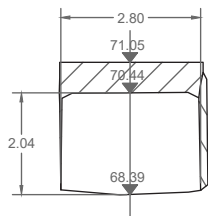

DATUM 67.00
LOCATION D-F01-01

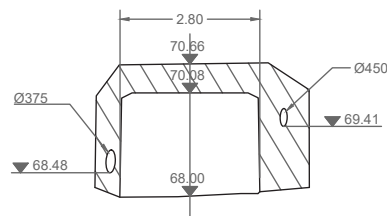

DATUM 67.00
LOCATION D-F01-02



STRUCTURE UPSTREAM



VIEW LOOKING UPSTREAM

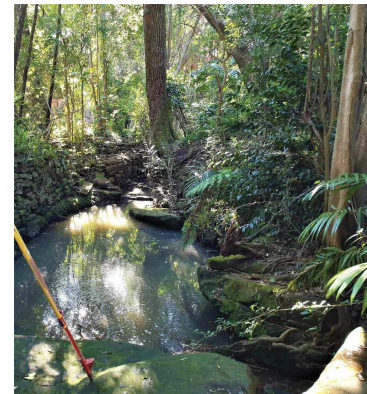

VIEW LOOKING DOWNSTREAM



STRUCTURE DOWNSTREAM

© PROJECT SURVEYORS - 2020
REPRODUCTION WITHOUT WRITTEN
APPROVAL IS STRICTLY PROHIBITED

BELLA VISTA

PO Box 7419
BAULKHAM HILLS NSW 2153

SUITE 405, LEVEL 4
14 LEXINGTON DRIVE
BELLA VISTA NSW 2153

PHONE : 9056 1900

email: office@projectsurveyors.com.au
www.projectsurveyors.com.au

ABN 20 068 433 974



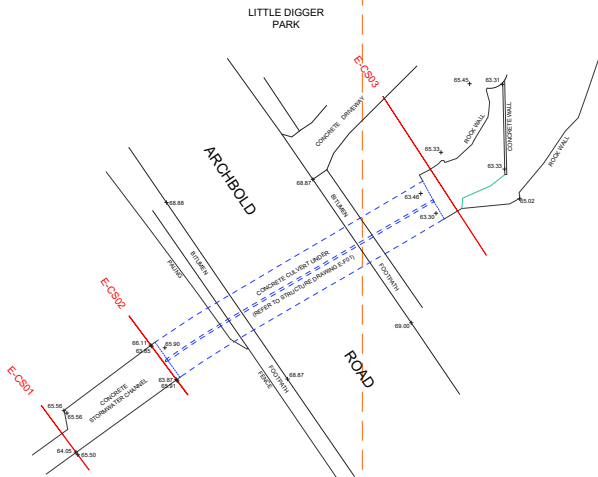
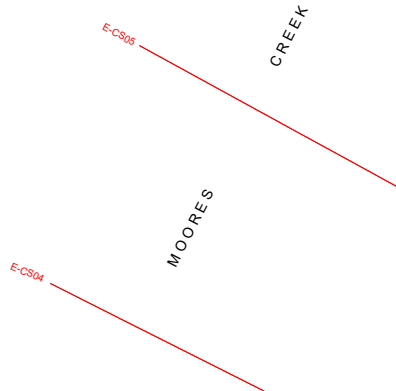
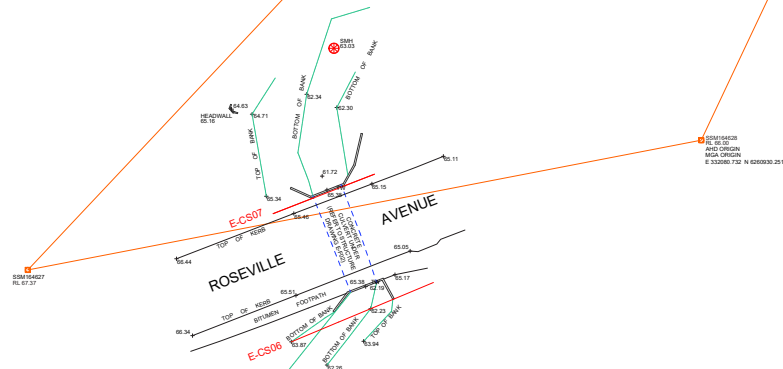
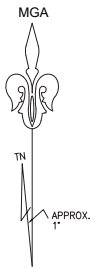

MGA (GDA94)



CAUTION
SURVEY DATA CONTAINED IN THIS FILE IS MGA (GDA94)
IT IS NOT THE MOST CURRENT TRANSFORMATION MGA2020 (GDA2020)
IT IS THE RESPONSIBILITY OF ANY USER OF THIS DATA TO ENSURE ANY
OTHER DATA BEING INTEGRATED IS THE SAME COORDINATE SYSTEM

MGA (GDA94) ORIGIN	SSM 164628	E 332080.732	N 6260930.251
MGA ORIENTATION	SSM164628 - SSM164629	25°16'46" - 125.953	
AHD ORIGIN	SSM 164628 RL 66.00	CLASS D	

A1

NOTES:
* BEARINGS RELATE TO MGA NORTH ORIGINATING FROM SCIMS.
* LEVEL DATUM IS AHD ORIGINATING FROM SSM 164628 - RL 66.00
* VISIBLE, ACCESSIBLE SERVICES ONLY HAVE BEEN LOCATED. THIS PLAN DOES NOT PURPORT TO SHOW UNDERGROUND SERVICES.
* THE EXISTENCE OF UNDERGROUND SERVICES HAS NOT BEEN ESTABLISHED.
* EXISTENCE OF SERVICES MUST BE VERIFIED BY CONTACTING DIAL BEFORE YOU DIG (DBYD) 1100.COM.AU
* CRITICAL SERVICES MUST BE EXPOSED AND LOCATED
* CONTOURS SHOWN ARE INDICATIVE OF LAND FORM. SPOT LEVELS SHOULD TAKE PRECEDENCE.
* THIS TITLEBLOCK IS AN INTEGRAL PART OF THIS DRAWING AND SHOULD NOT BE REMOVED.

LEGEND
SMH - SEWER MANHOLE



© PROJECT SURVEYORS - 2020 REPRODUCTION WITHOUT WRITTEN APPROVAL IS STRICTLY PROHIBITED		
REV	AMENDMENTS	DATE

CLIENT: BMT
PLAN OF: SECTION 8-9,
ARCHBOLD ROAD TO
ROSEVILLE AVENUE
ROSEVILLE
SHOWING: GENERAL DETAIL AND
CROSS SECTIONS LOCATION
PURPOSE: ARCHITECTURAL DESIGN
COUNCIL SUBMISSION
SHEET 1 OF 1

SCALE 1:250	
JOB REF. :	B04743
DRAWING No.	B04743-ZoneE
SURVEYOR:	BG & DY
CHECKED:	SD
DATE:	01/08/2020
DATUM:	A.H.D.
ORIGIN:	SSM 164628 - RL 66.00
REFERENCE SYSTEM:	MGA

BELLA VISTA
PO Box 7419
BAULKHAM HILLS NSW 2153
SUITE 405, LEVEL 4
14 LEXINGTON DRIVE
BELLA VISTA NSW 2153
PHONE : 9056 1900
email: office@projectsurveyors.com.au
www.projectsurveyors.com.au
ABN 20 058 433 974



E-CS01 ——— DENOTES LOCATION OF CROSS SECTION WITHIN ZONE E

MGA



PLAN VIEW

CULVERT UNDER ARCHBOLD ROAD ID: E-F01

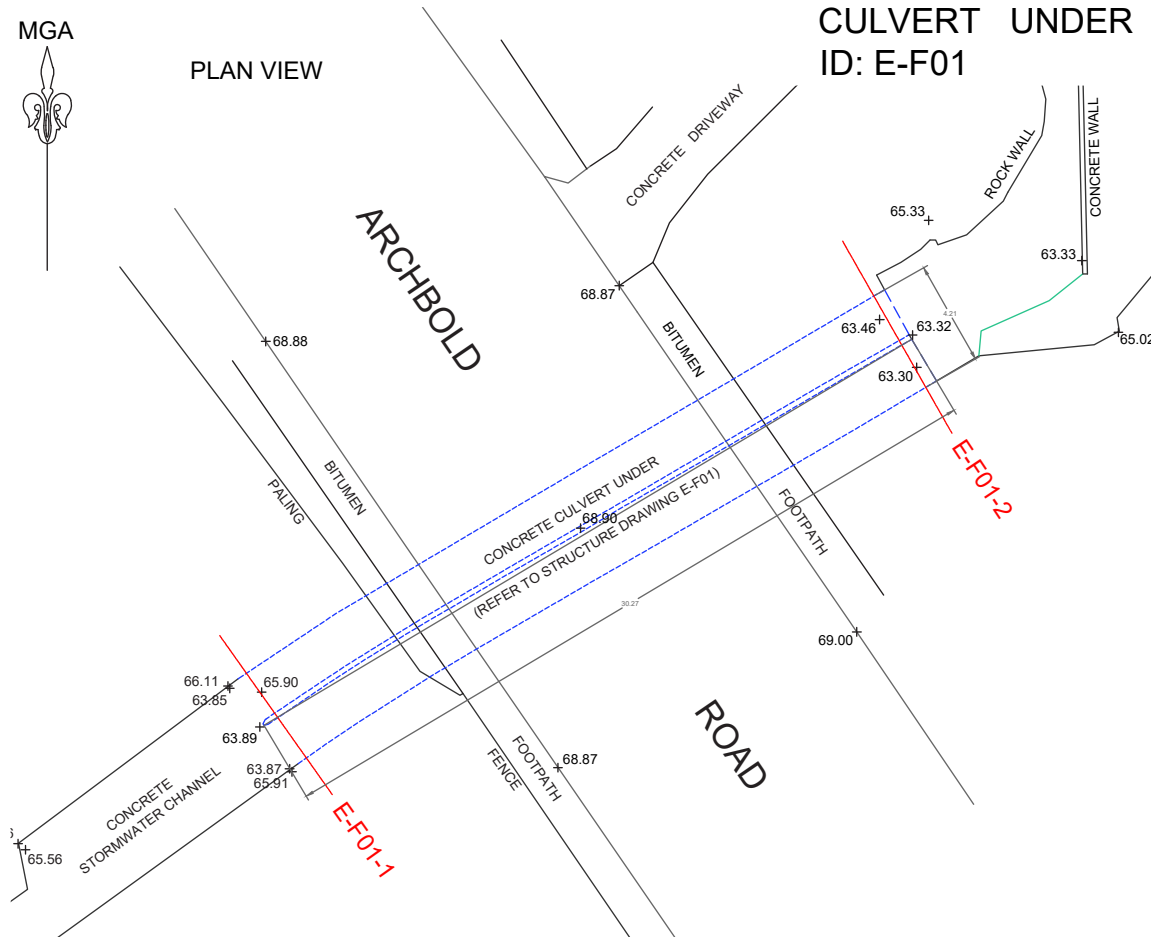

E-F01-1
VIEW LOOKING UPSTREAM



E-F01-1
STRUCTURE UPSTREAM



E-F01-2
STRUCTURE DOWNSTREAM



E-F01-2
VIEW LOOKING DOWNSTREAM

SECTION LOOKING DOWNSTREAM

SECTION LOOKING DOWNSTREAM

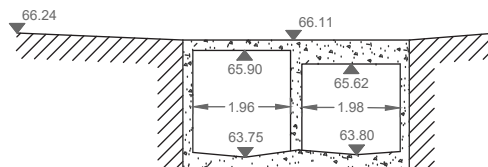

DATUM 62.00
LOCATION E-F01-1

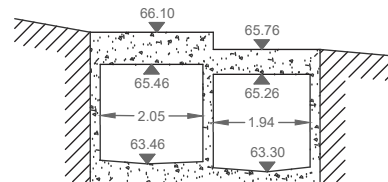

DATUM 62.00
LOCATION E-F01-2

REF No. B04743

© PROJECT SURVEYORS - 2020
REPRODUCTION WITHOUT WRITTEN
APPROVAL IS STRICTLY PROHIBITED

BELLA VISTA

PO Box 7419
BAULKHAM HILLS NSW 2153

SUITE 405, LEVEL 4
14 LEXINGTON DRIVE
BELLA VISTA NSW 2153

PHONE : 9056 1900

email: office@projectsurveyors.com.au
www.projectsurveyors.com.au

ABN 20 068 433 974



**PROJECT
SURVEYORS**

Professional Innovative... Results.

E-F02

HYDRAULIC STRUCTURE DRAWING

MGA

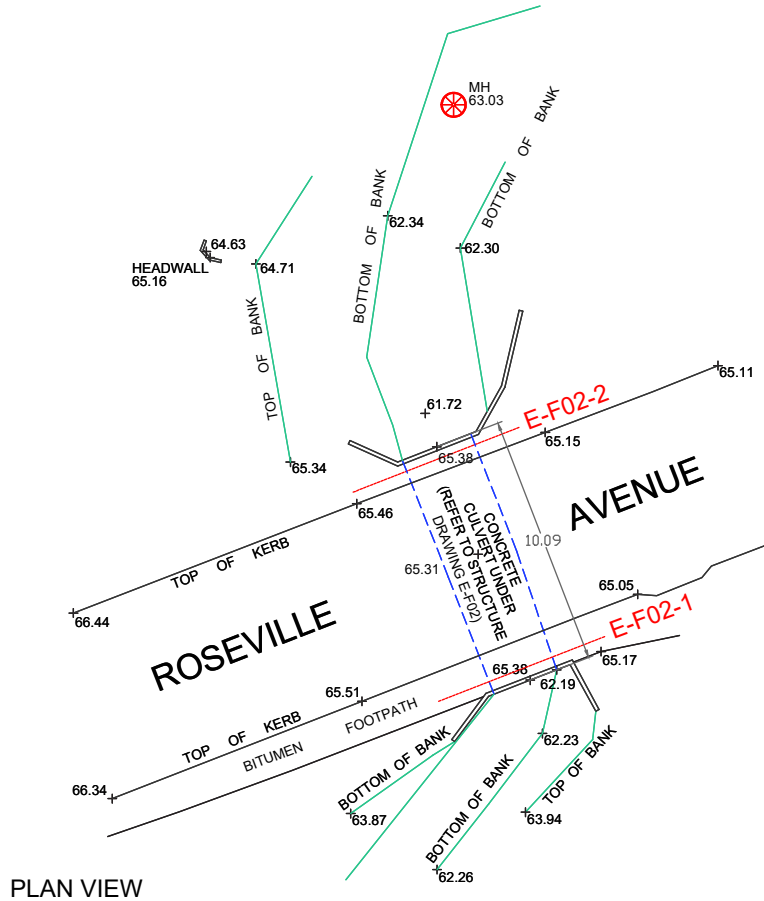

PLAN VIEW

SECTION LOOKING DOWNSTREAM

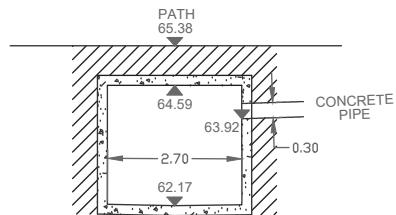

DATUM 61.00

LOCATION E-F02-1

SECTION LOOKING DOWNSTREAM

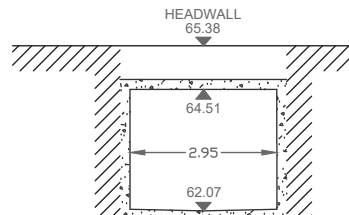

DATUM 61.00

LOCATION E-F02-2



E-F02-1
VIEW LOOKING UPSTREAM



E-F02-1
VIEW LOOKING DOWNSTREAM

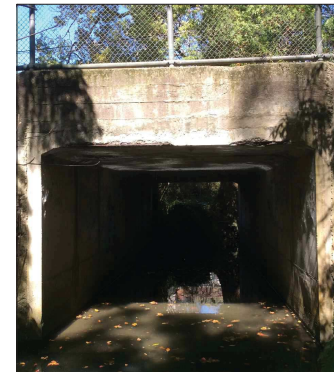

E-F02-2
VIEW LOOKING UPSTREAM

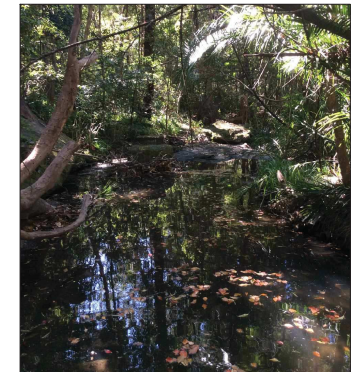

E-F02-2
VIEW LOOKING DOWNSTREAM

REF No. B04743

© PROJECT SURVEYORS - 2020
REPRODUCTION WITHOUT WRITTEN
APPROVAL IS STRICTLY PROHIBITED

BELLA VISTA

PO Box 7419
BAULKHAM HILLS NSW 2153

SUITE 405, LEVEL 4
14 LEXINGTON DRIVE
BELLA VISTA NSW 2153

PHONE : 9056 1900

email: office@projectsurveyors.com.au
www.projectsurveyors.com.au

ABN 20 068 433 974



**PROJECT
SURVEYORS**

Professional Innovative... Results.

MGA (GDA94)

SCIMS SURVEY MARK			
MGA (GDA94) ORIGIN			
NCR ORIENTATION	158164628	158164628	158164628
AHD ORIGIN	SSM 164628	RL 66.00	CLASS D

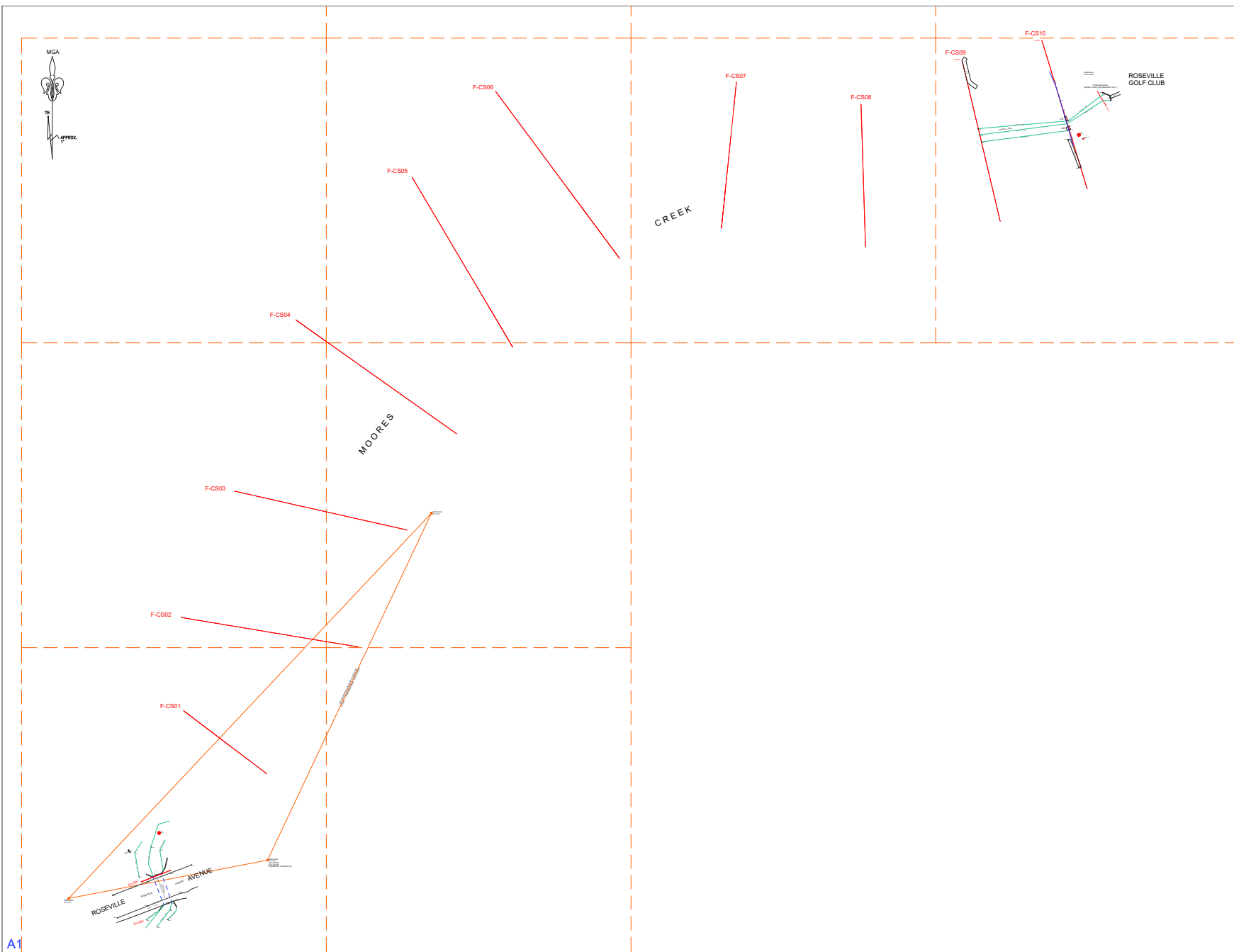

A1

NOTES:

- * BEARINGS RELATE TO MGA NORTH ORIGINATING FROM SCIMS.
- * LEVEL DATUM IS AHD ORIGINATING FROM SSM 164628 - RL 66.00.
- * VISIBLE, ACCESSIBLE SERVICES ONLY HAVE BEEN LOCATED. THIS PLAN DOES NOT PURPORT TO SHOW UNDERGROUND SERVICES.
- * THE EXISTENCE OF UNDERGROUND SERVICES HAS NOT BEEN ESTABLISHED.
- * EXISTENCE OF SERVICES MUST BE VERIFIED BY CONTACTING DIAL BEFORE YOU DIG (DBYD) 1100.COM.AU
- * CRITICAL SERVICES MUST BE EXPOSED AND LOCATED
- * CONTOURS SHOWN ARE INDICATIVE OF LAND FORM. SPOT LEVELS SHOULD TAKE PRECEDENCE.
- * THIS TITLEBLOCK IS AN INTEGRAL PART OF THIS DRAWING AND SHOULD NOT BE REMOVED.

F-CS01 ——— DENOTES LOCATION OF CROSS SECTION WITHIN ZONE F

LEGEND

SMH - SEWER MANHOLE
SVENT - SEWER VENT© PROJECT SURVEYORS - 2020
REPRODUCTION WITHOUT WRITTEN
APPROVAL IS STRICTLY PROHIBITED

REV	AMENDMENTS	DATE

CLIENT: BMT

PLAN OF: SECTION 9-10,
ROSEVILLE AVE TO
ROSEVILLE GOLFCLUB
ROSEVILLE
SHOWING: GENERAL DETAIL AND
CROSS SECTION LOCATIONPURPOSE: ARCHITECTURAL DESIGN
COUNCIL SUBMISSION
SHEET 1 OF 1

SCALE 1:200

JOB REF. :	B04743
DRAWING No.	B04743-ZoneF
SURVEYOR:	BG & DY
CHECKED:	SD
DATE:	01/08/2020
DATUM:	A.H.D.
ORIGIN:	SSM 164628 - RL 66.00
REFERENCE SYSTEM:	MGA

BELLA VISTA

PO Box 7419
BAULKHAM HILLS NSW 2153
SUITE 405, LEVEL 4
14 LEXINGTON DRIVE
BELLA VISTA NSW 2153
PHONE : 9056 1900
email: office@projectsurveyors.com.au
www.projectsurveyors.com.au
ABN 20 088 433 974

F-CS11

HYDRAULIC STRUCTURE DRAWING
WITHIN ROSEVILLE GOLF CLUB

MGA



PLAN VIEW

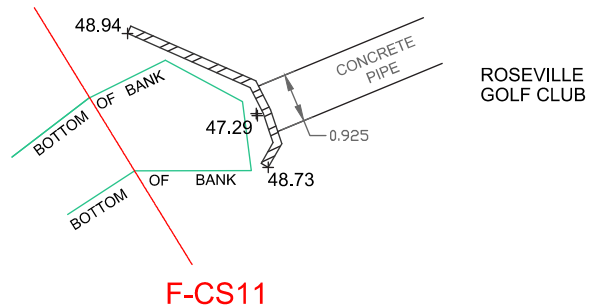

F-CS11



VIEW LOOKING DOWNSTREAM



VIEW LOOKING UPSTREAM

SECTION LOOKING DOWNSTREAM

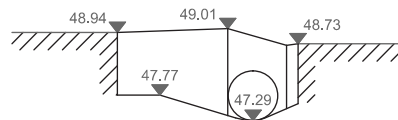

DATUM 46.00

LOCATION F-CS11

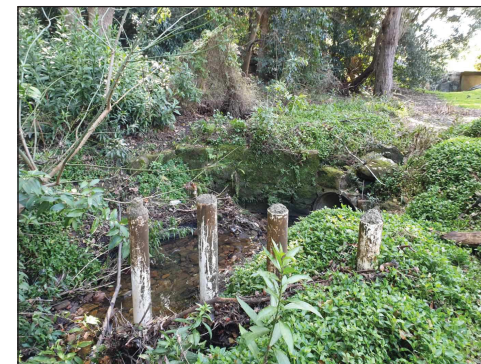

VIEW LOOKING DOWNSTREAM



© PROJECT SURVEYORS - 2020
REPRODUCTION WITHOUT WRITTEN
APPROVAL IS STRICTLY PROHIBITED

BELLA VISTA

PO Box 7419
BAULKHAM HILLS NSW 2153

SUITE 405, LEVEL 4
14 LEXINGTON DRIVE
BELLA VISTA NSW 2153

PHONE : 9056 1900

email: office@projectsurveyors.com.au
www.projectsurveyors.com.au
ABN 20 068 433 974



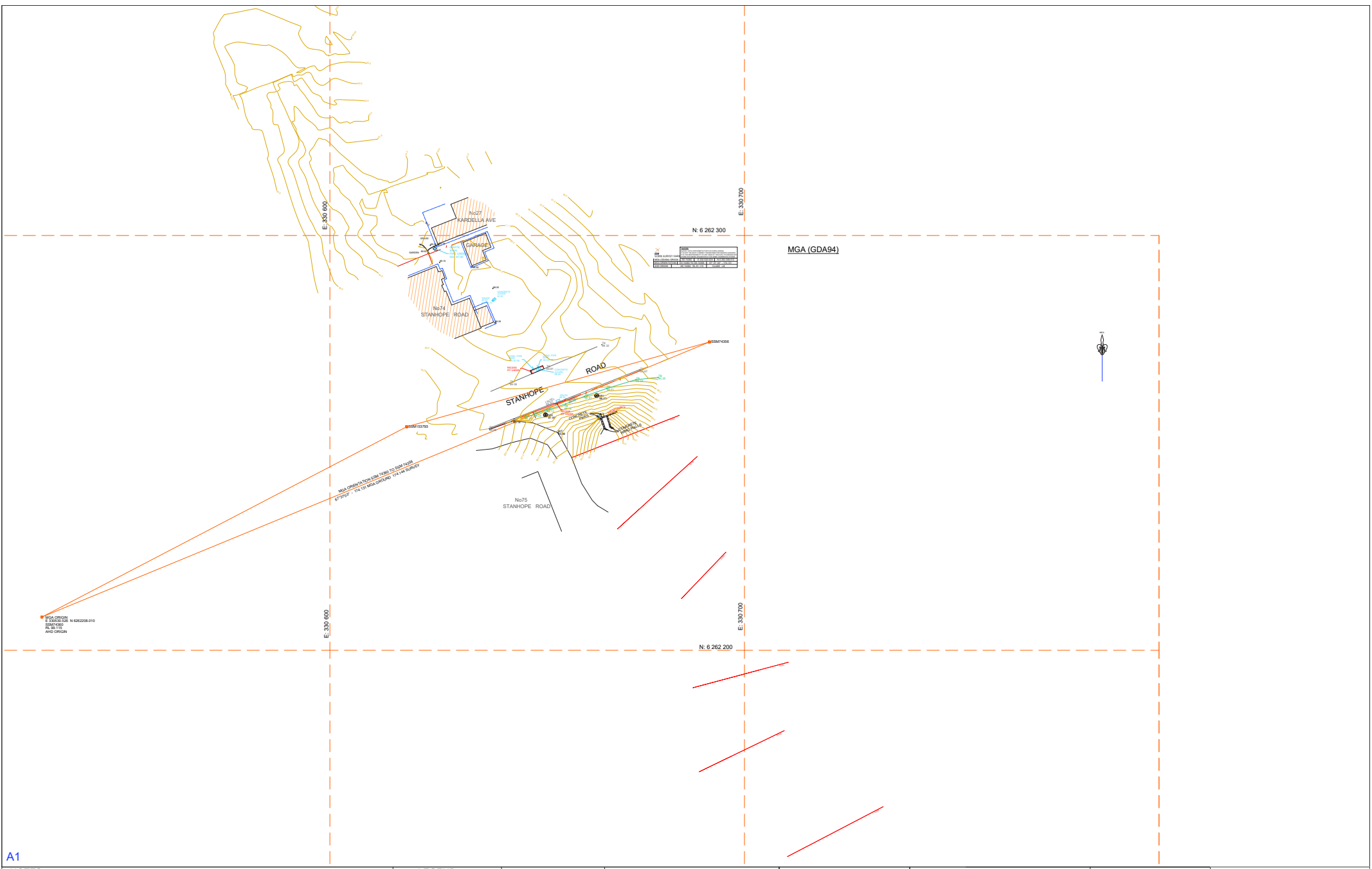

A1

NOTES:

- * BEARINGS RELATE TO MGA NORTH ORIGINATING FROM SCIMS.
- * LEVEL DATUM IS AHD ORIGINATING FROM 74360 RL 99.115
- * VISIBLE, ACCESSIBLE SERVICES ONLY HAVE BEEN LOCATED. THIS PLAN DOES NOT PURPORT TO SHOW UNDERGROUND SERVICES.
- * THE EXISTENCE OF UNDERGROUND SERVICES HAS NOT BEEN ESTABLISHED.
- * EXISTENCE OF SERVICES MUST BE VERIFIED BY CONTACTING DIAL BEFORE YOU DIG (DBYD) 1100.COM.AU
- * CRITICAL SERVICES MUST BE EXPOSED AND LOCATED
- * CONTOURS SHOWN ARE INDICATIVE OF LAND FORM. SPOT LEVELS SHOULD TAKE PRECEDENCE.
- * THIS TITLEBLOCK IS AN INTEGRAL PART OF THIS DRAWING AND SHOULD NOT BE REMOVED.

G-CS01 ——— DENOTES LOCATION OF CROSS SECTION WITHIN ZONE G

LEGEND

ELP - ELECTRIC LIGHT POLE
HYD - HYDRANT
TW - TOP WALL
TK - TOP KERB
TG - TOP GUTTER
PP - POWER POLE
SMH - SEWER MANHOLE
SP - SIGN POST
SV - STOP VALVE
TEL - TELSTRA PIT
VC - VEHICLE CROSSING
WM - WATER METER



© PROJECT SURVEYORS - 2020 REPRODUCTION WITHOUT WRITTEN APPROVAL IS STRICTLY PROHIBITED		
REV	AMENDMENTS	DATE

CLIENT: BMT

PLAN OF: SECTION 11-12,
STANHOPE ROAD,
KILLARA

SHOWING: GENERAL DETAIL AND
CROSS SECTION LOCATIONS

PURPOSE: ARCHITECTURAL DESIGN
COUNCIL SUBMISSION

SHEET 1 OF 1

SCALE 1:100

0 1 2 3 4 5 6 7 8 9 10

JOB REF. :	B04743
DRAWING No.	B04743-ZoneG
SURVEYOR:	BG & DY
CHECKED:	SD
REGISTERED LAND SURVEYOR	SEP 2020
DATE:	A.H.D.
DATUM:	SSM 74360 RL 99.115
ORIGIN:	A.H.D.
REFERENCE SYSTEM:	MGA

BELLA VISTA

PO Box 7419
BAULKHAM HILLS NSW 2153

SUITE 405, LEVEL 4
14 LEXINGTON DRIVE
BELLA VISTA NSW 2153

PHONE : 9056 1900

email: office@projectsurveyors.com.au
www.projectsurveyors.com.au
ABN 20 084 433 974

