

261 Mona Vale Road, St Ives

[Link to Department of Planning and Environment Tracker \(PP- 2023-2529\)](#)

CURRENT STATUS: Public Exhibition from 21/03/2024 to 19/04/2024

DETAILS: To reclassify Council owned land from Community land to Operational land

MAP:

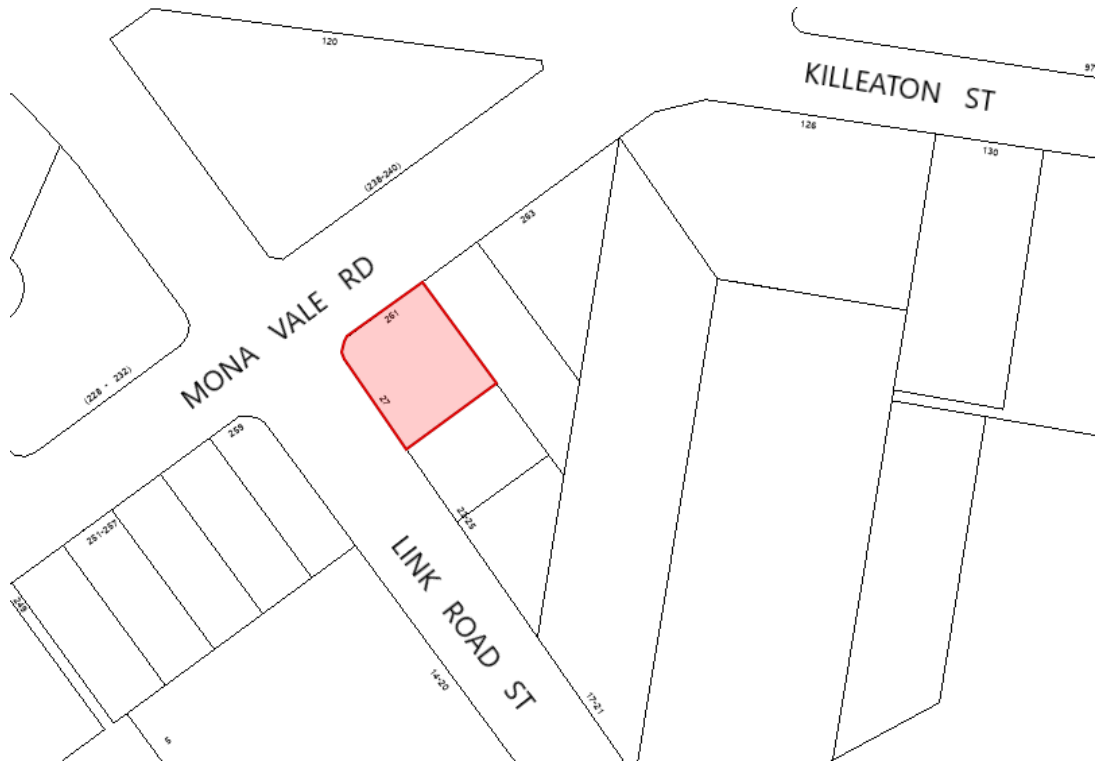

STATUS:

Description	Date
Referred to KLPP	20/03/23
Report to Council and Council Resolution - Deferred	20/6/23
Report to Council and Council Resolution – Progress to Gateway Determination	25/07/23
Gateway Determination Issued	13/03/2024
Public Exhibition	21/03/2024 – 19/04/2024
Next Steps:	Public Hearing to be held in May