

261 Mona Vale Road, St Ives

[Link to Department of Planning and Environment Tracker \(PP- 2023-2529\)](#)

CURRENT STATUS: Submitted for Gateway Determination

DETAILS: To reclassify Council owned land from Community Land to Operational Land

MAP:

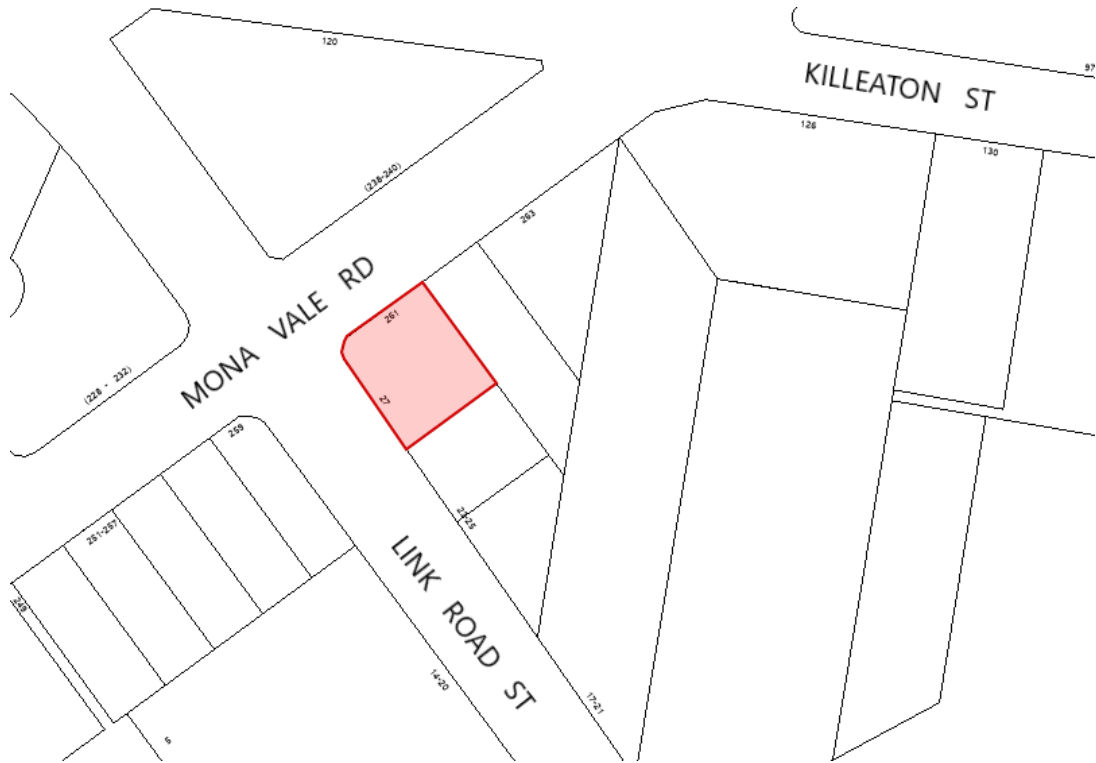

STATUS:

Description		Date
Referred to KLPP		20/03/23
Report to Council and Council Resolution - Deferred		20/6/23
Report to Council and Council Resolution – Progress to Gateway Determination		25/07/23
Next Steps:	Awaiting Gateway Determination	